



Willy Meyer+Sohn GmbH+Co. KG  
Stemmessiepener Weg 5  
58675 Hemer  
Germany  
Phone: +49 2372 9891-0  
Fax: +49 2372 9891-48  
E-mail: [info@meyer-lighting.com](mailto:info@meyer-lighting.com)  
[www.meyer-lighting.com](http://www.meyer-lighting.com)



**New Products 2024**



Metaspace is a new pole-top luminaire series with innovative light sources and optics. It is designed to meet high demands for sustainable illumination. Excellent glare control is achieved by indirect reflectors with LEDs which are completely shielded from view. These precise optics direct light solely onto the target area – the ground. Stray light into the sky is avoided. By using tuneable warm white colour temperatures, the orientation behaviour of insects remains undisturbed.

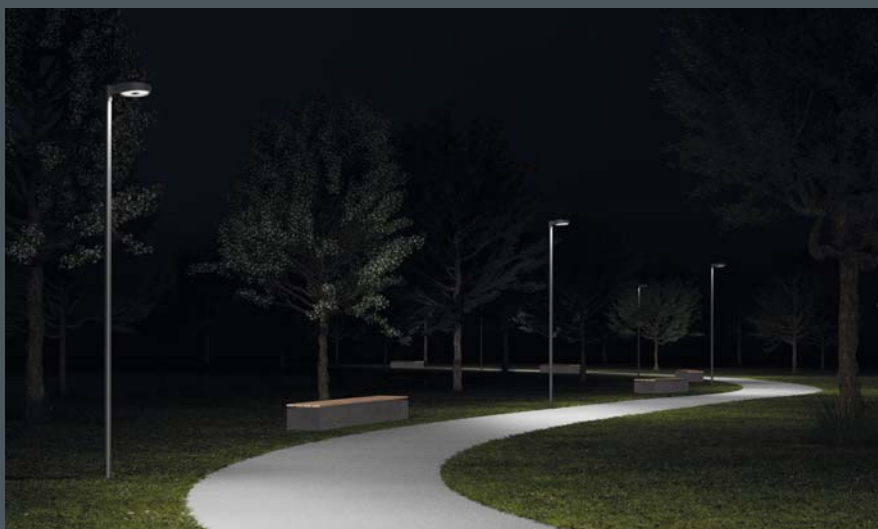

With dark sky compliant optics and perfect glare control Metaspace delivers the best light quality for humans and nocturnal animals.



With their exemplary design the luminaires are ideal for use in urban or landscaped architecture.

The light of LED modules, which are completely shielded from view, is projected onto an indirect reflector and redirected on the target area. This optic achieves excellent glare control.

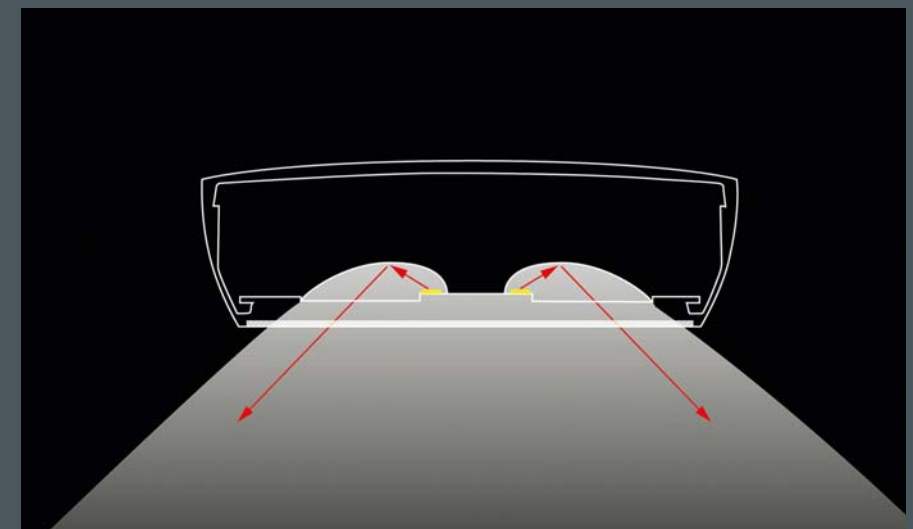

**Metaspace**

With highly efficient LED modules, integral temperature monitoring device, CRI: > 80, Colour tolerance: max. 3 SDCM  
 Service life: L80/B20 > 50 000 h  
 protection class I, IP65  $\blacklozenge$   $\blacktriangle$   $\blacktriangle$ , IK08  
 windage area AW 0.056 m<sup>2</sup>  
 corrosion-resistant die cast aluminium housing AlSi12, polyester powder coated, highly efficient metallised PC reflector, all exterior steel parts are stainless steel, tempered safety glass, silicon gasket, 5 stainless steel screws, pole top fitter for poles  $\varnothing$  60/76 mm, 4 M8 grub screws, M20 cable gland, with 8 m cable H07RN-F3G1, integral driver (AC/DC)

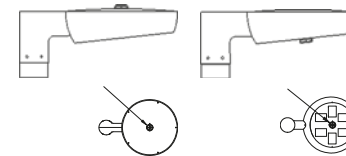
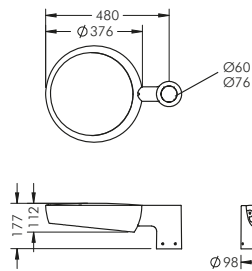

The luminaires can be equipped with a Zhaga-18 interface for communication and sensing on the top and at the bottom.

Part number	Description
... 7 ...	Protection class II luminaire
... 8 ...	Luminaire in "High Output" version for protection class II
... 7 ...	Luminaire with warm white LED module (2700 K)
... 1 ...	Dimmable luminaire (DALI)
... 3 ...	Luminaire with Zhaga-18 interface for communication (top)
... 4 ...	Luminaire with Zhaga-18 interface for sensing (bottom)
... 5 ...	Luminaire with Zhaga-18 interface for communication (top) and sensing (bottom)

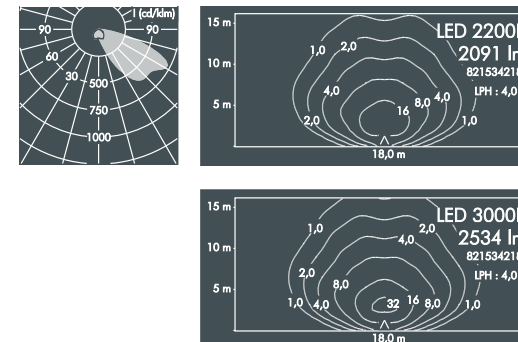

**Metaspace, Adjustable White, asymmetrical wide beam \***

Part number	Colour	Weight	Light source	Luminous flux	Beam angle $\gamma$ (FWHM)	
8 215 342 189	black	5.1 kg	12 x LED warm white (2200 K) and 12 x LED warm white (3000 K) (max 27 W)	2091 lm to 2534 lm	C 0 - 180	C 90 - 270
8 215 362 189	white				60°	116°
8 215 352 189	silver grey					

\* Luminaires are available with asymmetrical beam or lateral wide beam upon request.

**Metaspace, asymmetrical beam**

Part number*	Colour	Weight	Light source	Luminous flux	Main beam angle $\gamma$
8 215 346 049	black	5.1 kg	6 x LED module 6.3 W (38 W)	3741 lm	63°
8 215 366 049	white				
8 215 356 049	silver grey				

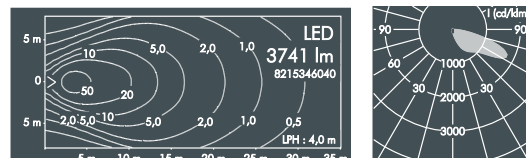

**Metaspace, asymmetrical beam, High Output**

Part number*	Colour	Weight	Light source	Luminous flux	Main beam angle $\gamma$
8 216 346 049	black	5.1 kg	6 x LED module 10.8 W (65 W)	6072 lm	63°
8 216 366 049	white				
8 216 356 049	silver grey				

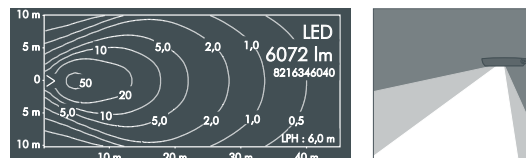

**Metaspace, asymmetrical wide beam**

Part number*	Colour	Weight	Light source	Luminous flux	Beam angle $\gamma$ (FWHM)	
8 215 346 089	black	5.1 kg	6 x LED module 6.3 W (38 W)	3661 lm	C 0 - 180	C 90 - 270
8 215 366 089	white				64°	133°
8 215 356 089	silver grey				warm white (3000 K)	

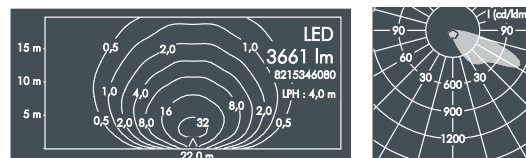

**Metaspace, asymmetrical wide beam High Output**

Part number*	Colour	Weight	Light source	Luminous flux	Beam angle $\gamma$ (FWHM)	
8 216 346 089	black	5.1 kg	6 x LED Modul 10.8 W (65 W)	5942 lm	C 0 - 180	C 90 - 270
8 216 366 089	white				64°	133°
8 216 356 089	silver grey				warm white (3000 K)	

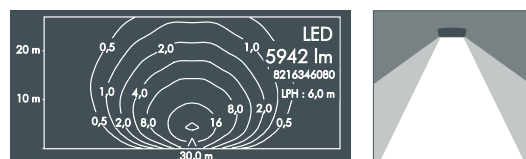

**Metaspace, lateral wide beam**

Part number*	Colour	Weight	Light source	Luminous flux	Beam angle $\gamma$ (FWHM)	
8 215 346 059	black	5.1 kg	6 x LED module 6.3 W (38 W)	3647 lm	C 0 - 180	C 90 - 270
8 215 366 059	white				46°	142°
8 215 356 059	silver grey				warm white (3000 K)	

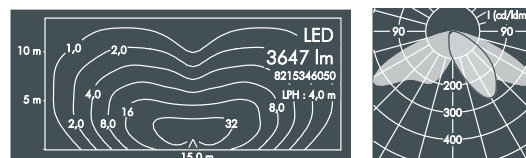

**Metaspace, lateral wide beam, High Output**

Part number*	Colour	Weight	Light source	Luminous flux	Beam angle $\gamma$ (FWHM)	
8 216 346 059	black	5.1 kg	6 x LED module 10.8 W (65 W)	5919 lm	C 0 - 180	C 90 - 270
8 216 366 059	white				46°	142°
8 216 356 059	silver grey				warm white (3000 K)	

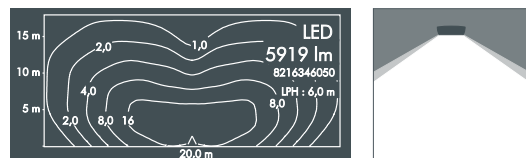

**Metaspace, Street Optic**

Part number*	Colour	Weight	Light source	Luminous flux	Beam angle $\gamma$ (FWHM)	
8 215 346 099	black	5.0 kg	6 x LED module 8.6 W (52 W)	5772 lm	C 0 - 180	C 90 - 270
8 215 366 099	white				57°	148°
8 215 356 099	silver grey				warm white (3000 K)	

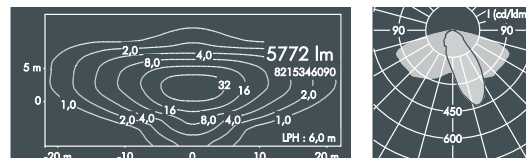

**Metaspace Adjustable White**

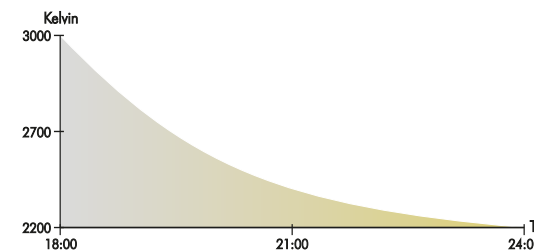

With the Adjustable White light control it is possible to adapt colour temperatures for sustainable exterior lighting applications.



As the night progresses, colour temperatures can be adapted to the needs of sustainable illumination throughout the seasons. Operating luminaires at approximately 3000 Kelvin is efficient and recommended during busy hours.

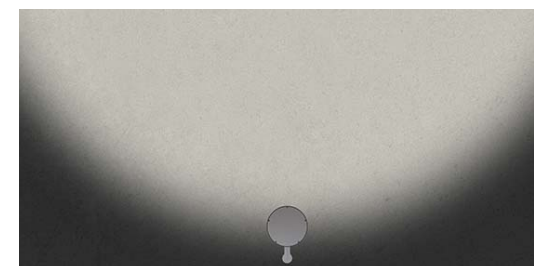

Later in the evening the requirement for high energy efficiency gradually becomes less important. The luminaires are switched to operate with warm white colour temperatures of about 2700 Kelvin. The light quality becomes more inviting and insects are attracted less.



During late hours, while few people stay outside, the protection of the night environment takes precedence. By operating luminaires with approximately 2700 Kelvin the orientation behavior of insects and nocturnal animals is disturbed only minimally.

\* Find more versions on page 5.

**LED** Luminaires available in 2200 K or other colour temperatures upon request





The new floodlight series Metaspot combines exemplary design with innovative optics. The elliptical shape of the luminaires harmonizes especially well with landscape architecture. The new Darkring optics are a breakthrough development for effective glare control. For Metaspot a pole-top fitter with an integral Zhaga-18 interface is available as an accessory. By the use of an antenna, up to 4 luminaires on one pole can be controlled and monitored individually. In addition to pole luminaires, there are versions for surface mounting.

Metaspot pole luminaires with various sizes and optics can be combined for imaginative lighting of exterior spaces. The floodlights are equipped with a turn-and-tilt fixing system for flexible orientation. Possible applications range from uniform illumination of paths and public areas to highlighting of objects. A gobo projector version completes the series.



Green Heart,  
University of Birmingham  
Lighting design: Speirs Major, London

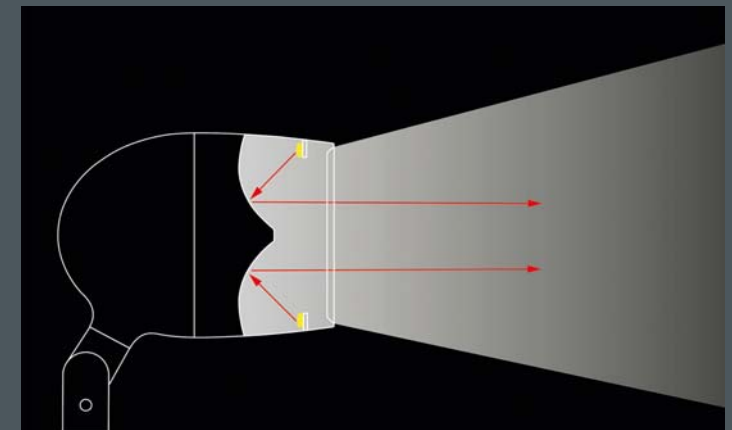

With the innovative Darkring optic light from a circular LED board is projected onto the target area via an indirect reflector. The light source is shielded from view and excellent glare control is achieved.

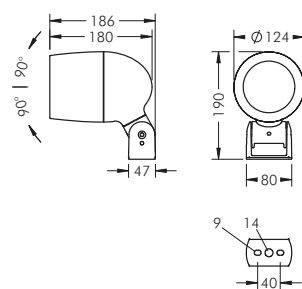

**Metaspot 1 with mounting bracket**  
 With high performance LED module (Zhaga), integral temperature monitoring device, CRI: > 80, Colour tolerance: 3 SDCM Service life: L80/B10 > 50 000 h protection class I or II, IP65  $\blacklozenge\blacktriangle\blacktriangle$ , IK08 windage area AW 0.023 m<sup>2</sup> corrosion-resistant die cast aluminium housing AlSi12, polyester powder coated, highly efficient aluminium reflector or PMMA lens (Street Optic), all exterior steel parts are stainless steel, tempered safety glass, silicon gasket, toolless twist lock for closure, mounting bracket: 2 drilled holes  $\varnothing$  9 mm, spacing 40 mm, 1 centre hole  $\varnothing$  14 mm, tilt range 180°, M20 cable gland, integral driver (AC/DC)

**Metaspot 1 pole luminaire**  
 With high performance LED module (Zhaga), integral temperature monitoring device, CRI: > 80, Colour tolerance: 3 SDCM Service life: L80/B10 > 50 000 h protection class I or II, IP65  $\blacklozenge\blacktriangle\blacktriangle$ , IK08 windage area AW 0.026 m<sup>2</sup> corrosion-resistant die cast aluminium housing AlSi12, polyester powder coated, highly efficient aluminium reflector or PMMA lens (Street Optic), all exterior steel parts are stainless steel, tempered safety glass, silicon gasket, toolless twist lock for closure, for installation on poles  $\varnothing$  60 - 100 mm, tiltable base made of powder coated aluminium, 2 drilled holes  $\varnothing$  9 mm, spacing 95 mm, 1 centre hole  $\varnothing$  40 mm, tilt range 90°, swivel range 360°, M20 cable gland, integral driver (AC/DC)

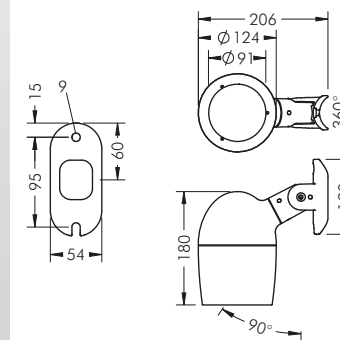

Metaspot 1, narrow beam					
Part number	Colour	Weight	Light source	Luminous flux	Beam angle $\gamma$ (FWHM)
8 241 046 019	black	2.1 kg	1 x LED module 15 W warm white (3000 K)	1099 lm	8°
8 241 066 019	white				
8 241 056 019	silver grey				

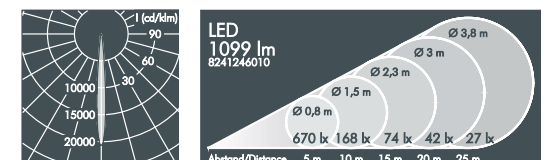
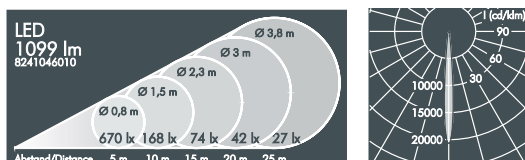

Metaspot 1 pole luminaire, narrow beam					
Part number	Colour	Weight	Light source	Luminous flux	Beam angle $\gamma$ (FWHM)
8 241 246 019	black	2.1 kg	1 x LED module 15 W warm white (3000 K)	1099 lm	8°
8 241 266 019	white				
8 241 256 019	silver grey				

Metaspot 1, linear beam spread, vertical					
Part number	Colour	Weight	Light source	Luminous flux	Beam angle $\gamma$ (FWHM)
8 241 046 029	black	2.1 kg	1 x LED module 15 W warm white (3000 K)	1171 lm	C 0 - 180
8 241 066 029	white				C 90 - 270
8 241 056 029	silver grey				36°

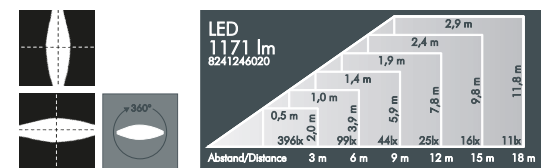
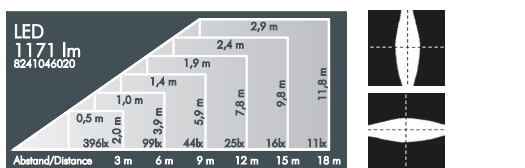

Metaspot 1 pole luminaire, linear beam spread, vertical					
Part number	Colour	Weight	Light source	Luminous flux	Beam angle $\gamma$ (FWHM)
8 241 246 029	black	2.1 kg	1 x LED module 15 W warm white (3000 K)	1171 lm	C 0 - 180
8 241 266 029	white				C 90 - 270
8 241 256 029	silver grey				36°

... 3. Luminaire with linear beam spread, horizontal

... 3. Luminaire with linear beam spread, horizontal  
 ... 7. Luminaire with linear beam spread, rotatable

Metaspot 1, linear beam spread, rotatable					
Part number	Colour	Description	Luminous flux	Beam angle $\gamma$ (FWHM)	
8 241 046 079	black	Luminaire with external ribbed glass spreader lens, continuously adjustable through 360° from outside the luminaire	1011 lm	C 0 - 180	
8 241 066 079	white			C 90 - 270	
8 241 056 079	silver grey			36°	9°

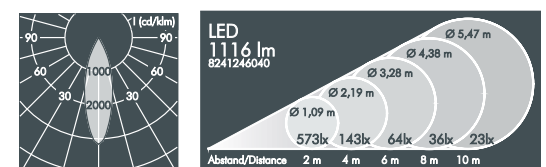
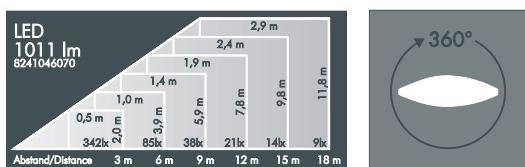

Metaspot 1 pole luminaire, medium wide beam					
Part number	Colour	Weight	Light source	Luminous flux	Beam angle $\gamma$ (FWHM)
8 241 246 049	black	2.1 kg	1 x LED module 15 W warm white (3000 K)	1116 lm	31°
8 241 266 049	white				
8 241 256 049	silver grey				

Metaspot 1, medium wide beam					
Part number	Colour	Weight	Light source	Luminous flux	Beam angle $\gamma$ (FWHM)
8 241 046 049	black	2.1 kg	1 x LED module 15 W warm white (3000 K)	1116 lm	31°
8 241 066 049	white				
8 241 056 049	silver grey				

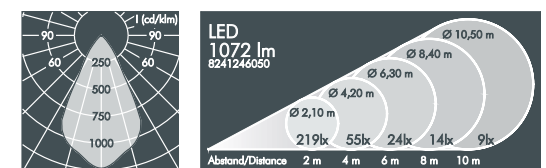
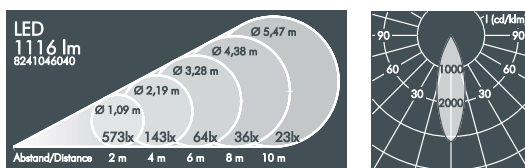

Metaspot 1 pole luminaire, wide beam					
Part number	Colour	Weight	Light source	Luminous flux	Beam angle $\gamma$ (FWHM)
8 241 246 059	black	2.1 kg	1 x LED module 15 W warm white (3000 K)	1072 lm	55°
8 241 266 059	white				
8 241 256 059	silver grey				

Metaspot 1, wide beam					
Part number	Colour	Weight	Light source	Luminous flux	Beam angle $\gamma$ (FWHM)
8 241 046 059	black	2.1 kg	1 x LED module 15 W warm white (3000 K)	1072 lm	55°
8 241 066 059	white				
8 241 056 059	silver grey				

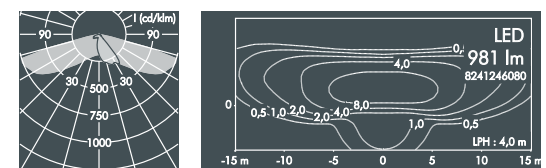
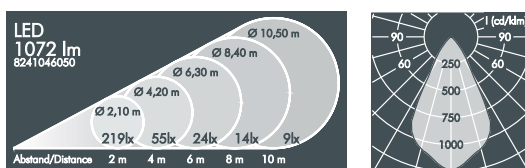

Metaspot 1 pole luminaire, Street Optic					
Part number	Colour	Weight	Light source	Luminous flux	Beam angle $\gamma$ (FWHM)
8 241 246 089	black	2.2 kg	1 x LED module 15 W warm white (3000 K)	981 lm	C 0 - 180
8 241 266 089	white				C 90 - 270
8 241 256 089	silver grey				41°

Metaspot 1, Street Optic					
Part number	Colour	Weight	Light source	Luminous flux	Beam angle $\gamma$ (FWHM)
8 241 046 089	black	2.2 kg	1 x LED module 14 W warm white (3000 K)	981 lm	C 0 - 180
8 241 066 089	white				C 90 - 270
8 241 056 089	silver grey				41°

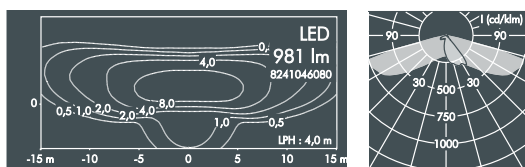

Part number	Description
... 5 ...	Protection class II luminaire
... 7 ...	Luminaire with warm white LED module (2700 K)
... 1 ...	Dimmable luminaire (DALI)

Part number	Description
... 5 ...	Protection class II luminaire
... 7 ...	Luminaire with warm white LED module (2700 K)
... 1 ...	Dimmable luminaire (DALI)



LED  
 Luminaires available in 2200 K or other colour temperatures upon request



LED  
 Luminaires available in 2200 K or other colour temperatures upon request

Accessories Metaspot 1			
Part number	Description		
129 0 728 940	Radial louvre, internal		factory fitted,
129 0 752 000	Honeycomb louvre, iinternal		(not available for Street Optic)
	Colour		
122 0 571 940	black	Cowl, stainless steel, to avoid lateral glare, for retro-fitting	external, for retro-fitting
122 0 571 960	white		
122 0 571 950	silver grey		

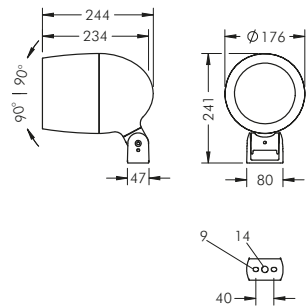

**Metaspot 2 with mounting bracket**  
 With high performance LED module (Zhaga), integral temperature monitoring device, CRI: > 80, Colour tolerance: 3 SDCM  
 Service life: L90/B10 > 50 000 h  
 protection class I or II, IP65  $\blacklozenge\blacktriangle\blacktriangle$ , IK08  
 windage area AW 0.042 m<sup>2</sup>  
 corrosion-resistant die cast aluminium housing AlSi12, polyester powder coated,  
 highly efficient aluminium reflector or lens made of optical silicon (Street Optic),  
 all exterior steel parts are stainless steel, tempered safety glass, silicon gasket,  
 toolless twist lock for closure,  
 mounting bracket: 2 drilled holes  $\varnothing$  9 mm, spacing 40 mm, 1 centre hole  $\varnothing$  14 mm,  
 tilt range 180°, M20 cable gland,  
 integral driver (AC/DC)

**Metaspot 2 Darkring Optic with mounting bracket**  
 With highly efficient LED modules, integral temperature monitoring device, CRI: > 80, Colour tolerance: 3 SDCM  
 Service life: L80/B10 > 50 000 h  
 protection class I or II, IP65  $\blacklozenge\blacktriangle\blacktriangle$ , IK08  
 windage area AW 0.042 m<sup>2</sup>  
 corrosion-resistant die cast aluminium housing AlSi12, polyester powder coated,  
 light source completely shielded, high gloss aluminum reflector,  
 all exterior steel parts are stainless steel, tempered safety glass, silicon gasket,  
 toolless twist lock for closure,  
 mounting bracket: 2 drilled holes  $\varnothing$  9 mm, spacing 40 mm, 1 centre hole  $\varnothing$  14 mm,  
 tilt range 180°, M20 cable gland,  
 integral driver (AC/DC)

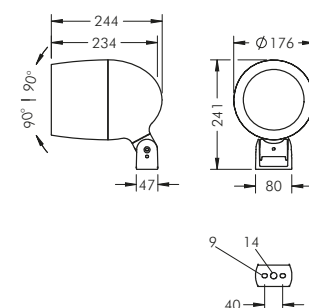

Metaspot 2, narrow beam					
Part number	Colour	Weight	Light source	Luminous flux	Beam angle $\gamma$ (FWHM)
8 242 046 019	black	3.6 kg	1 x LED module 35 W warm white (3000 K)	3510 lm	10°
8 242 066 019	white				
8 242 056 019	silver grey				

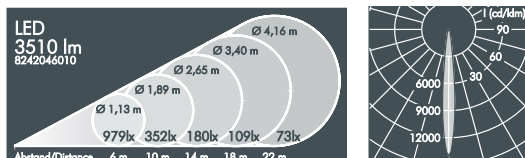

Metaspot 2, linear beam spread, vertical					
Part number	Colour	Weight	Light source	Luminous flux	Beam angle $\gamma$ (FWHM)
8 242 046 029	black	3.6 kg	1 x LED module 35 W warm white (3000 K)	3032 lm	C 0 - 180
8 242 066 029	white				C 90 - 270
8 242 056 029	silver grey				36°

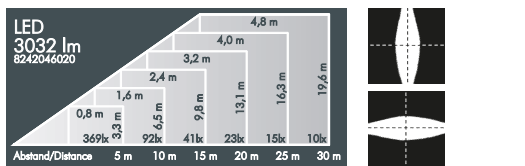

... 3. Luminaire with linear beam spread, horizontal

Metaspot 2, linear beam spread, rotatable					
Part number	Colour	Description	Luminous flux	Beam angle $\gamma$ (FWHM)	
8 242 046 079	black	Luminaire with external ribbed glass spreader lens, continuously adjustable through 360° from outside the luminaire	2791 lm	C 0 - 180	
8 242 066 079	white			C 90 - 270	
8 242 056 079	silver grey			36°	

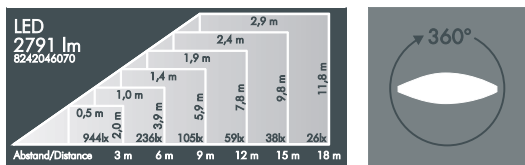

Metaspot 2, medium wide beam					
Part number	Colour	Weight	Light source	Luminous flux	Beam angle $\gamma$ (FWHM)
8 242 046 049	black	3.6 kg	1 x LED module 35 W warm white (3000 K)	3519 lm	30°
8 242 066 049	white				
8 242 056 049	silver grey				

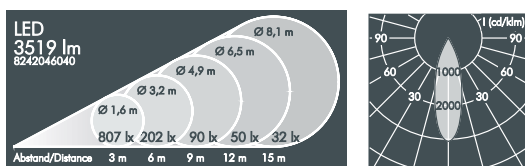

Metaspot 2, wide beam					
Part number	Colour	Weight	Light source	Luminous flux	Beam angle $\gamma$ (FWHM)
8 242 046 059	black	3.6 kg	1 x LED module 35 W warm white (3000 K)	3588 lm	53°
8 242 066 059	white				
8 242 056 059	silver grey				

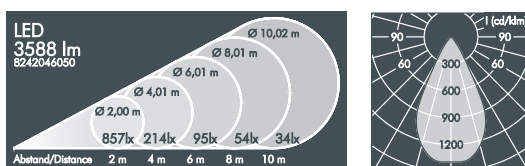

Metaspot 2, Street Optic					
Part number	Colour	Weight	Light source	Luminous flux	Beam angle $\gamma$ (FWHM)
8 242 046 089	black	3.7 kg	1 x LED module 35 W warm white (3000 K)	3451 lm	C 0 - 180
8 242 066 089	white				C 90 - 270
8 242 056 089	silver grey				51°

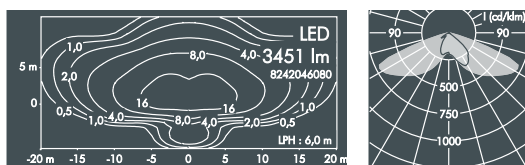

Part number	Description
... 6 ...	Protection class II luminaire
... 7 ...	Luminaire with warm white LED module (2700 K)
... 1 ...	Dimmable luminaire (DALI)
... 3 ...	Luminaire with Zhaga-18 interface for communication



LED  
 Luminaires available in 2200 K or other colour temperatures upon request

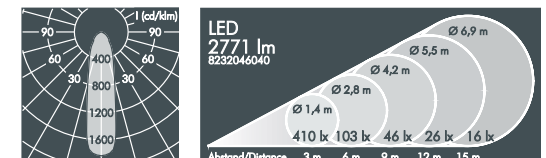

Metaspot 2 Darkring Optic, medium wide beam					
Part number	Colour	Weight	Light source	Luminous flux	Beam angle $\gamma$ (FWHM)
8 232 046 049	black	3.8 kg	3 x LED module 13 W (39 W) warm white (3000 K)	2771 lm	27°
8 232 066 049	white				
8 232 056 049	silver grey				

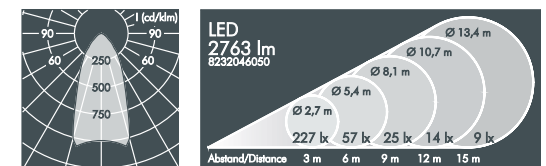

Metaspot 2 Darkring Optic, wide beam					
Part number	Colour	Weight	Light source	Luminous flux	Beam angle $\gamma$ (FWHM)
8 232 046 059	black	3.8 kg	3 x LED module 13 W (39 W) warm white (3000 K)	2763 lm	48°
8 232 066 059	white				
8 232 056 059	silver grey				

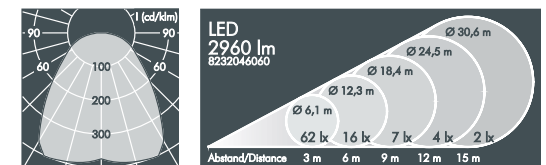

Metaspot 2 Darkring Optic, extra wide beam					
Part number	Colour	Weight	Light source	Luminous flux	Beam angle $\gamma$ (FWHM)
8 232 046 069	black	3.8 kg	3 x LED module 13 W (39 W) warm white (3000 K)	2960 lm	91°
8 232 066 069	white				
8 232 056 069	silver grey				

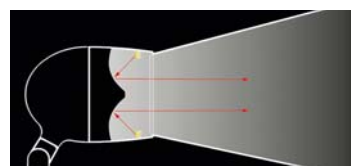

Part number	Description
... 6 ...	Protection class II luminaire
... 7 ...	Luminaire with warm white LED module (2700 K)
... 1 ...	Dimmable luminaire (DALI)
... 3 ...	Luminaire with Zhaga-18 interface for communication

Accessories Metaspot 2 external, for retro-fitting			
Part number	Colour	Description	
122 0 572 940	black	Cowl, stainless steel, to avoid lateral glare, for retro-fitting	
122 0 572 960	white		
122 0 572 950	silver grey		

Accessories Metaspot 2 internal, factory fitted (not available for Darkring Optic/Street Optic)			
Part number	Description		
129 0 729 940	Radial louvre, internal (factory fitted), to reduce lateral glare		

Part number	Description
129 0 893 000	Honeycomb louvre, internal (factory fitted), to avoid glare

LED  
 Luminaires available in 2200 K or other colour temperatures upon request



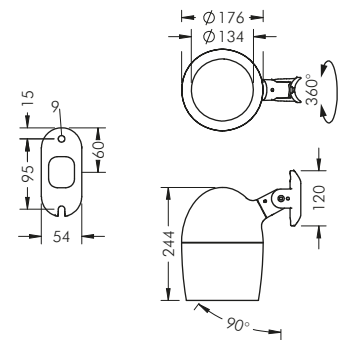

**Metaspot 2 pole luminaire**

With high performance LED module (Zhaga), integral temperature monitoring device, CRI: > 80, Colour tolerance: 3 SDCM Service life: L90/B10 > 50 000 h protection class I or II, IP65  $\blacklozenge$   $\blacktriangle$   $\blacktriangle$ , IK08 windage area AAV 0.045 m<sup>2</sup> corrosion-resistant die cast aluminium housing AlSi12, polyester powder coated, highly efficient aluminium reflector or lens made of optical silicon (Street Optic), all exterior steel parts are stainless steel, tempered safety glass, silicon gasket, toolless twist lock for closure, for installation on poles  $\varnothing$  60 - 100 mm, tiltable base made of powder coated aluminium, 2 drilled holes  $\varnothing$  9 mm, spacing 95 mm, 1 centre hole  $\varnothing$  40 mm, tilt range 90°, swivel range 360°, M20 cable gland, integral driver (AC/DC)

**Metaspot 2 Darkring Optic pole luminaire**

With highly efficient LED modules, integral temperature monitoring device, CRI: > 80, Colour tolerance: 3 SDCM Service life: L80/B10 > 50 000 h protection class I or II, IP65  $\blacklozenge$   $\blacktriangle$   $\blacktriangle$ , IK08 windage area AAV 0.045 m<sup>2</sup> corrosion-resistant die cast aluminium housing AlSi12, polyester powder coated, light source completely shielded, high gloss aluminum reflector, all exterior steel parts are stainless steel, tempered safety glass, silicon gasket, toolless twist lock for closure, for installation on poles  $\varnothing$  60 - 100 mm, tiltable base made of powder coated aluminium, 2 drilled holes  $\varnothing$  9 mm, spacing 95 mm, 1 centre hole  $\varnothing$  40 mm, tilt range 90°, swivel range 360°, M20 cable gland, integral driver (AC/DC)

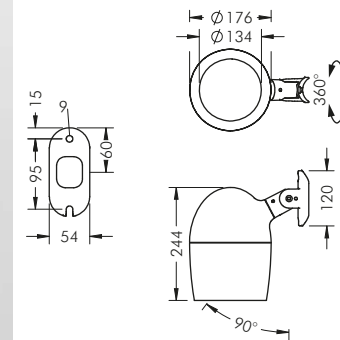

**Metaspot 2 pole luminaire, narrow beam**

Part number	Colour	Weight	Light source	Luminous flux	Beam angle $\gamma$ (FWHM)
8 242 246 019	black	3.6 kg	1 x LED module 35 W	3510 lm	10°
8 242 266 019	white		warm white (3000 K)		
8 242 256 019	silver grey				

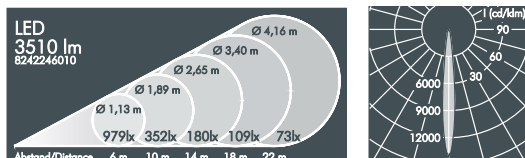

**Metaspot 2 pole luminaire, linear beam spread, vertical**

Part number	Colour	Weight	Light source	Luminous flux	Beam angle $\gamma$ (FWHM)
8 242 246 029	black	3.6 kg	1 x LED module 35 W	3032 lm	C 0 - 180 C 90 - 270
8 242 266 029	white		warm white (3000 K)		36° 9°
8 242 256 029	silver grey				



**... 3. Luminaire with linear beam spread, horizontal**

**Metaspot 2 pole luminaire, linear beam spread, rotatable**

Part number	Colour	Description	Luminous flux	Beam angle $\gamma$ (FWHM)
8 242 246 079	black	<b>Luminaire with external ribbed glass spreader lens,</b> continuously adjustable through 360° from outside the luminaire	2791 lm	C 0 - 180 C 90 - 270
8 242 266 079	white		36° 9°	
8 242 256 079	silver grey			

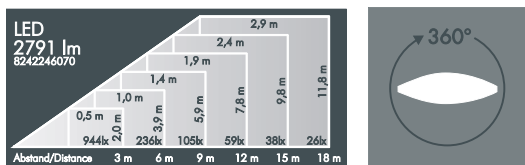

**Metaspot 2 pole luminaire, medium wide beam**

Part number	Colour	Weight	Light source	Luminous flux	Beam angle $\gamma$ (FWHM)
8 242 246 049	black	3.6 kg	1 x LED module 35 W	3519 lm	30°
8 242 266 049	white		warm white (3000 K)		
8 242 256 049	silver grey				

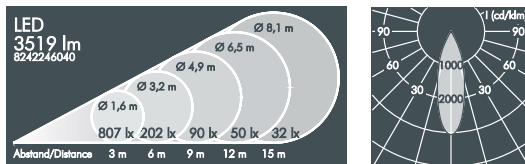

**Metaspot 2 pole luminaire, wide beam**

Part number	Colour	Weight	Light source	Luminous flux	Beam angle $\gamma$ (FWHM)
8 242 246 059	black	3.6 kg	1 x LED module 35 W	3588 lm	53°
8 242 266 059	white		warm white (3000 K)		
8 242 256 059	silver grey				

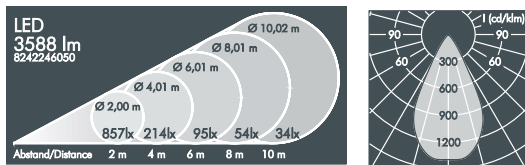

**Metaspot 2 pole luminaire, Street Optic**

Part number	Colour	Weight	Light source	Luminous flux	Beam angle $\gamma$ (FWHM)
8 242 246 089	black	3.7 kg	1 x LED module 35 W	3451 lm	C 0 - 180 C 90 - 270
8 242 266 089	white		warm white (3000 K)		51° 141°
8 242 256 089	silver grey				

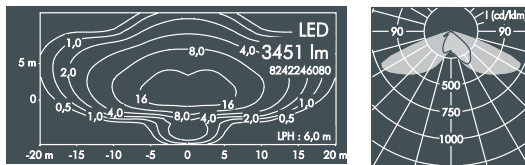

Part number	Description
... 6 ...	Protection class II luminaire
... 7 ...	Luminaire with warm white LED module (2700 K)
... 1 ...	Dimmable luminaire (DALI)
... 2 ...	Dimmable luminaire (DALI D4i)
... 3 ...	Luminaire with Zhaga-18 interface for communication



LED Luminaires available in 2200 K or other colour temperatures upon request



**Metaspot 2 Darkring Optic pole luminaire, medium wide beam**

Part number	Colour	Weight	Light source	Luminous flux	Beam angle $\gamma$ (FWHM)
8 232 246 049	black	3.8 kg	3 x LED module 13 W	2271 lm	27°
8 232 266 049	white		(39 W)		
8 232 256 049	silver grey		warm white (3000 K)		



**Metaspot 2 Darkring Optic pole luminaire, wide beam**

Part number	Colour	Weight	Light source	Luminous flux	Beam angle $\gamma$ (FWHM)
8 232 246 059	black	3.8 kg	3 x LED module 13 W	2763 lm	48°
8 232 266 059	white		(39 W)		
8 232 256 059	silver grey		warm white (3000 K)		



**Metaspot 2 Darkring Optic pole luminaire, extra wide beam**

Part number	Colour	Weight	Light source	Luminous flux	Beam angle $\gamma$ (FWHM)
8 232 246 069	black	3.8 kg	3 x LED module 13 W	2960 lm	91°
8 232 266 069	white		(39 W)		
8 232 256 069	silver grey		warm white (3000 K)		



Part number	Description
... 6 ...	Protection class II luminaire
... 7 ...	Luminaire with warm white LED module (2700 K)
... 1 ...	Dimmable luminaire (DALI)
... 2 ...	Dimmable luminaire (DALI D4i)
... 3 ...	Luminaire with Zhaga-18 interface for communication

**Accessories Metaspot 2 external, for retro-fitting**

Part number	Colour	Description
122 0 572 940	black	<b>Cowl</b> , stainless steel, to avoid lateral glare, for retro-fitting
122 0 572 960	white	
122 0 572 950	silver grey	

**Accessories Metaspot 2 internal, factory fitted (not available for Darkring Optic/Street Optic)**

Part number	Description
129 0 729 940	<b>Radial louvre</b> , internal (factory fitted), to reduce lateral glare
129 0 893 000	<b>Honeycomb louvre</b> , internal (factory fitted), to avoid glare

**Accessories Metaspot 2 pole luminaire**

Part number	Part number	Colour	Description
120 0 699 940	120 0 700 940	black	<b>Post-top fitter</b> for insertion, with Zhaga 18-interface, with 8 m cable, for control and monitoring of max. 4 luminaires with D4i LED driver
120 0 699 960	120 0 700 960	white	
120 0 699 950	120 0 700 950	silver grey	

LED Luminaires available in 2200 K or other colour temperatures upon request



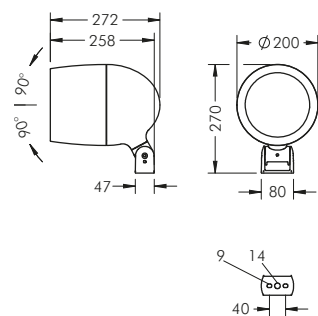

**Metaspot 3 with mounting bracket**  
 With high performance LED module (Zhaga), integral temperature monitoring device, CRI: > 80, Colour tolerance: 3 SDCM  
 Service life: L80/B10 > 50 000 h  
 protection class I or II, IP65  $\blacklozenge\blacklozenge\blacklozenge$ , IK08  
 windage area AW 0.052 m<sup>2</sup>  
 corrosion-resistant die cast aluminium housing AlSi12, polyester powder coated,  
 highly efficient aluminium reflector or lens made of optical silicon (Street Optic), all exterior steel parts are stainless steel, tempered safety glass, silicon gasket, toolless twist lock for closure,  
 mounting bracket: 2 drilled holes  $\varnothing$  9 mm, spacing 40 mm, 1 centre hole  $\varnothing$  14 mm, tilt range 180°, M20 cable gland, integral driver (AC/DC)

**Metaspot 3 Darkring Optic with mounting bracket**  
 With highly efficient LED modules, integral temperature monitoring device, CRI: > 80, Colour tolerance: 3 SDCM  
 Service life: L80/B10 > 50 000 h  
 protection class I or II, IP65  $\blacklozenge\blacklozenge\blacklozenge$ , IK08  
 windage area AW 0.052 m<sup>2</sup>  
 corrosion-resistant die cast aluminium housing AlSi12, polyester powder coated,  
 light source completely shielded, high gloss aluminum reflector, all exterior steel parts are stainless steel, tempered safety glass, silicon gasket, toolless twist lock for closure,  
 mounting bracket: 2 drilled holes  $\varnothing$  9 mm, spacing 40 mm, 1 centre hole  $\varnothing$  14 mm, tilt range 180°, M20 cable gland, integral driver (AC/DC)

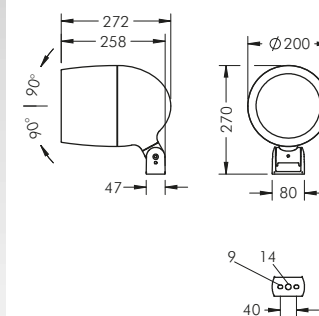

Metaspot 3, narrow beam					
Part number	Colour	Weight	Light source	Luminous flux	Beam angle $\gamma$ (FWHM)
8 243 046 019	black	5.0 kg	1 x LED module 67 W warm white (3000 K)	5653 lm	9°
8 243 066 019	white				
8 243 056 019	silver grey				

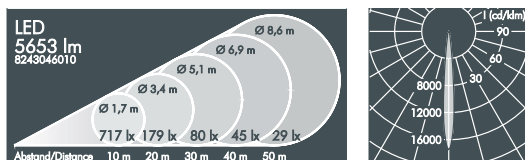

Metaspot 3, linear beam spread, vertical					
Part number	Colour	Weight	Light source	Luminous flux	Beam angle $\gamma$ (FWHM)
8 243 046 029	black	5.0 kg	1 x LED module 67 W warm white (3000 K)	4899 lm	C 0 – 180
8 243 066 029	white				C 90 – 270
8 243 056 029	silver grey				36°



... 3. Luminaire with linear beam spread, horizontal

Metaspot 3, linear beam spread, rotatable					
Part number	Colour	Description	Luminous flux	Beam angle $\gamma$ (FWHM)	
8 243 046 079	black	Luminaire with external ribbed glass spreader lens, continuously adjustable through 360° from outside the luminaire	4427 lm	C 0 – 180	C 90 – 270
8 243 066 079	white			36°	9°
8 243 056 079	silver grey			Weight 5.4 kg	

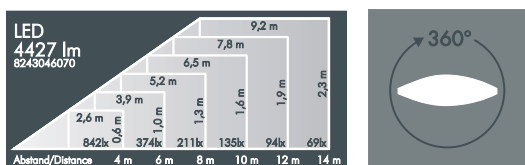

Metaspot 3, medium wide beam					
Part number	Colour	Weight	Light source	Luminous flux	Beam angle $\gamma$ (FWHM)
8 243 046 049	black	5.0 kg	1 x LED module 67 W warm white (3000 K)	5631 lm	36°
8 243 066 049	white				
8 243 056 049	silver grey				

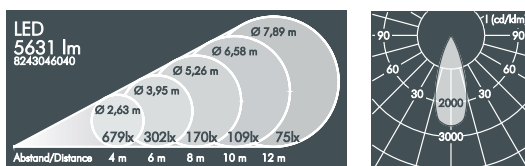

Metaspot 3, wide beam					
Part number	Colour	Weight	Light source	Luminous flux	Beam angle $\gamma$ (FWHM)
8 243 046 059	black	5.0 kg	1 x LED module 67 W warm white (3000 K)	5462 lm	57°
8 243 066 059	white				
8 243 056 059	silver grey				

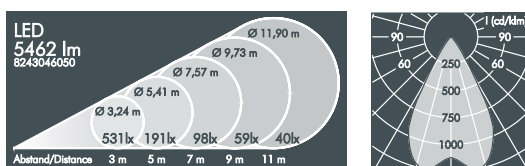

Metaspot 3, Street Optic					
Part number	Colour	Weight	Light source	Luminous flux	Beam angle $\gamma$ (FWHM)
8 243 046 089	black	5.0 kg	1 x LED module 67 W warm white (3000 K)	7311 lm	C 0 – 180
8 243 066 089	white				C 90 – 270
8 243 056 089	silver grey				60°

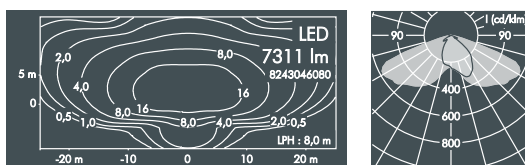

Part number	Description
... 7 ...	Protection class II luminaire
... 7 ...	Luminaire with warm white LED module (2700 K)
... 1 ...	Dimmable luminaire (DALI)
... 3 ...	Luminaire with Zhaga-18 interface for communication
... 9 0 ...	Luminaire with LED module RGBW * max. 49 W

\* Not available for Street Optic/Darkring Optic

LED Luminaires available in 2200 K or other colour temperatures upon request



LED Luminaires available in 2200 K or other colour temperatures upon request



Metaspot 3 Darkring Optic, medium wide beam					
Part number	Colour	Weight	Light source	Luminous flux	Beam angle $\gamma$ (FWHM)
8 233 046 049	black	4.4 kg	3 x LED module 19 W (58 W)	4113 lm	26°
8 233 066 049	white				
8 233 056 049	silver grey				

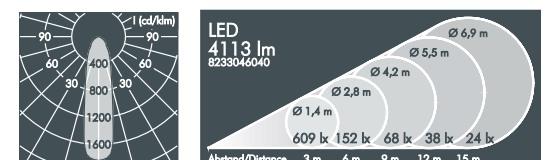

Metaspot 3 Darkring Optic, wide beam					
Part number	Colour	Weight	Light source	Luminous flux	Beam angle $\gamma$ (FWHM)
8 233 046 059	black	4.4 kg	3 x LED module 19 W (58 W)	4149 lm	54°
8 233 066 059	white				
8 233 056 059	silver grey				

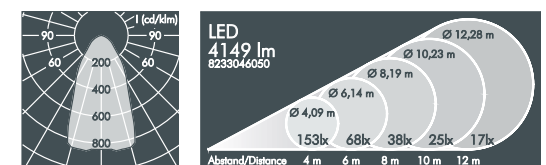

Metaspot 3 Darkring Optic, extra wide beam					
Part number	Colour	Weight	Light source	Luminous flux	Beam angle $\gamma$ (FWHM)
8 233 046 069	black	4.4 kg	3 x LED module 19 W (58 W)	4576 lm	91°
8 233 066 069	white				
8 233 056 069	silver grey				

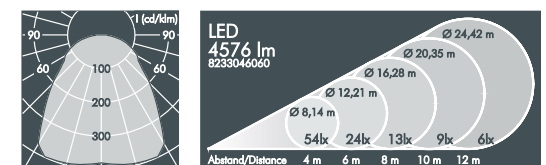

Part number	Description
... 6 ...	Protection class II luminaire
... 7 ...	Luminaire with warm white LED module (2700 K)
... 1 ...	Dimmable luminaire (DALI)
... 3 ...	Luminaire with Zhaga-18 interface for communication

Accessories Metaspot 3 external, for retro-fitting			
Part number	Colour	Description	
122 0 573 940	black	Cowl, stainless steel, to avoid lateral glare, for retro-fitting	
122 0 573 960	white		
122 0 573 950	silver grey		



Accessories Metaspot 3 internal, factory fitted (not available for Darkring Optic/Street Optic)			
Part number	Description		
129 0 730 940	Radial louvre, internal (factory fitted), to reduce lateral glare		

Part number	Description
129 0 754 000	Honeycomb louvre, internal (factory fitted), to avoid glare

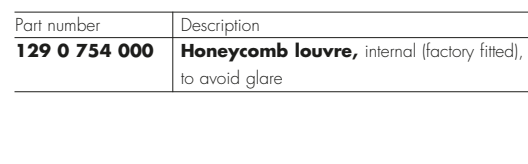



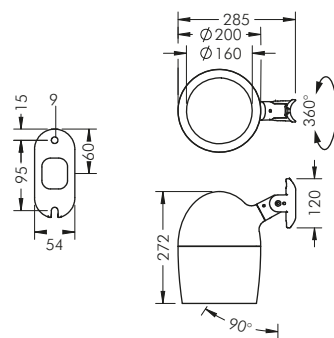

**Metaspot 3 pole luminaire**

With high performance LED module (Zhaga), integral temperature monitoring device, CRI: > 80, Colour tolerance: 3 SDCM  
 Service life: L80/B10 > 50 000 h  
 protection class I or II, IP65  $\blacklozenge$   $\blacktriangle$   $\blacktriangle$ , IK08  
 windage area A<sub>W</sub> 0.055 m<sup>2</sup>  
 corrosion-resistant die cast aluminium housing AlSi12, polyester powder coated,  
 highly efficient aluminium reflector or lens made of optical silicon (Street Optic),  
 all exterior steel parts are stainless steel, tempered safety glass, silicon gasket,  
 toolless twist lock for closure,  
 for installation on poles  $\varnothing$  60 - 100 mm,  
 tiltable base made of powder coated aluminium,  
 2 drilled holes  $\varnothing$  9 mm, spacing 95 mm,  
 1 centre hole  $\varnothing$  40 mm, tilt range 90°, swivel range 360°, M20 cable gland,  
 integral driver (AC/DC)

**Metaspot 3 Darkring Optic pole luminaire**

With highly efficient LED modules, integral temperature monitoring device, CRI: > 80, Colour tolerance: 3 SDCM  
 Service life: L80/B10 > 50 000 h  
 protection class I or II, IP65  $\blacklozenge$   $\blacktriangle$   $\blacktriangle$ , IK08  
 windage area A<sub>W</sub> 0.055 m<sup>2</sup>  
 corrosion-resistant die cast aluminium housing AlSi12, polyester powder coated,  
 light source completely shielded, high gloss aluminum reflector,  
 all exterior steel parts are stainless steel, tempered safety glass, silicon gasket,  
 toolless twist lock for closure,  
 for installation on poles  $\varnothing$  60 - 100 mm,  
 tiltable base made of powder coated aluminium,  
 2 drilled holes  $\varnothing$  9 mm, spacing 95 mm,  
 1 centre hole  $\varnothing$  40 mm, tilt range 90°, swivel range 360°, M20 cable gland,  
 integral driver (AC/DC)

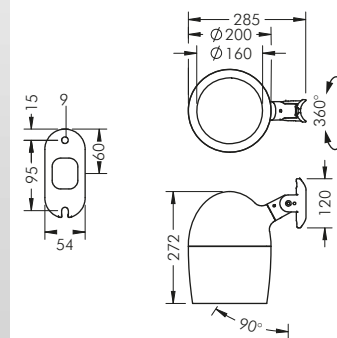

**Metaspot 3 pole luminaire, narrow beam**

Part number	Colour	Weight	Light source	Luminous flux	Beam angle $\gamma$ (FWHM)
<b>8 243 246 019</b>	black	5.0 kg	1 x LED module 67 W	5653 lm	9°
<b>8 243 266 019</b>	white		warm white (3000 K)		
<b>8 243 256 019</b>	silver grey				

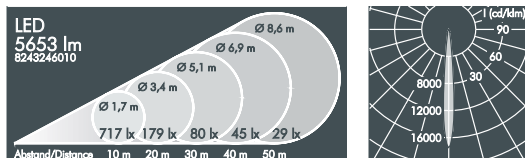

**Metaspot 3 pole luminaire, linear beam spread, vertical**

Part number	Colour	Weight	Light source	Luminous flux	Beam angle $\gamma$ (FWHM)
<b>8 243 246 029</b>	black	5.0 kg	1 x LED module 67 W	4899 lm	C 0 - 180 C 90 - 270
<b>8 243 266 029</b>	white		warm white (3000 K)		36° 9°
<b>8 243 256 029</b>	silver grey				



**... 3. Luminaire with linear beam spread, horizontal**

**Metaspot 3 pole luminaire, linear beam spread, rotatable**

Part number	Colour	Description	Luminous flux	Beam angle $\gamma$ (FWHM)
<b>8 243 246 079</b>	black	<b>Luminaire with external ribbed glass spreader lens,</b> continuously adjustable through 360° from outside the luminaire	4427 lm	C 0 - 180 C 90 - 270
<b>8 243 266 079</b>	white			36° 9°
<b>8 243 256 079</b>	silver grey			

Weight 5.4 kg

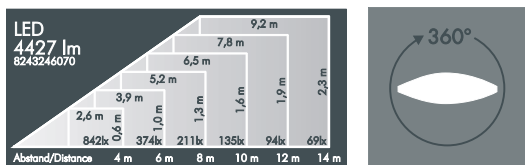

**Metaspot 3 pole luminaire, medium wide beam**

Part number	Colour	Weight	Light source	Luminous flux	Beam angle $\gamma$ (FWHM)
<b>8 243 246 049</b>	black	5.0 kg	1 x LED module 67 W	5631 lm	36°
<b>8 243 266 049</b>	white		warm white (3000 K)		
<b>8 243 256 049</b>	silver grey				

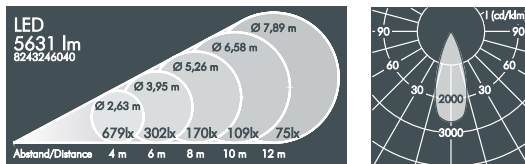

**Metaspot 3 pole luminaire, wide beam**

Part number	Colour	Weight	Light source	Luminous flux	Beam angle $\gamma$ (FWHM)
<b>8 243 246 059</b>	black	5.0 kg	1 x LED module 67 W	5462 lm	57°
<b>8 243 266 059</b>	white		warm white (3000 K)		
<b>8 243 256 059</b>	silver grey				

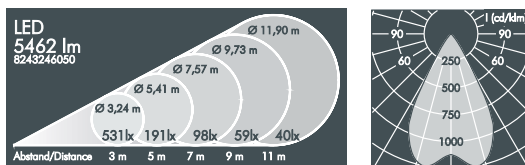

**Metaspot 3 pole luminaire, Street Optic**

Part number	Colour	Weight	Light source	Luminous flux	Beam angle $\gamma$ (FWHM)
<b>8 243 246 089</b>	black	5.0 kg	1 x LED module 67 W	7311 lm	C 0 - 180 C 90 - 270
<b>8 243 266 089</b>	white		warm white (3000 K)		60° 142°
<b>8 243 256 089</b>	silver grey				

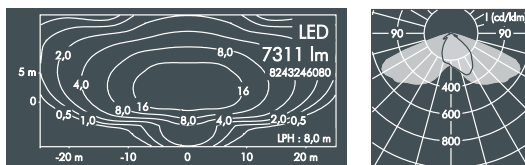

Part number	Description
<b>... 7 ...</b>	<b>Protection class II luminaire</b>
<b>... 7 ...</b>	<b>Luminaire with warm white LED module (2700 K)</b>
<b>... 1 ...</b>	<b>Dimmable luminaire (DALI)</b>
<b>... 2 ...</b>	<b>Dimmable luminaire (DALI D4i)</b>
<b>... 3 ...</b>	<b>Luminaire with Zhaga-18 interface for communication</b>
<b>... 9 0 ...</b>	<b>Luminaire with LED module RGBW * max. 49 W</b>

\* Not available for Street Optic/Darkring Optic

**LED** Luminaires available in 2200 K or other colour temperatures upon request



**Metaspot 3 Darkring Optic pole luminaire, medium wide beam**

Part number	Colour	Weight	Light source	Luminous flux	Beam angle $\gamma$ (FWHM)
<b>8 233 246 049</b>	black	4.4 kg	3 x LED module 19 W	4113 lm	26°
<b>8 233 266 049</b>	white		(58 W)		
<b>8 233 256 049</b>	silver grey		warm white (3000 K)		



**Metaspot 3 Darkring Optic pole luminaire, wide beam**

Part number	Colour	Weight	Light source	Luminous flux	Beam angle $\gamma$ (FWHM)
<b>8 233 246 059</b>	black	4.4 kg	3 x LED module 19 W	4149 lm	54°
<b>8 233 266 059</b>	white		(58 W)		
<b>8 233 256 059</b>	silver grey		warm white (3000 K)		



**Metaspot 3 Darkring Optic pole luminaire, extra wide beam**

Part number	Colour	Weight	Light source	Luminous flux	Beam angle $\gamma$ (FWHM)
<b>8 233 246 069</b>	black	4.4 kg	3 x LED module 19 W	4576 lm	91°
<b>8 233 266 069</b>	white		(58 W)		
<b>8 233 256 069</b>	silver grey		warm white (3000 K)		



Part number	Description
<b>... 7 ...</b>	<b>Protection class II luminaire</b>
<b>... 7 ...</b>	<b>Luminaire with warm white LED module (2700 K)</b>
<b>... 1 ...</b>	<b>Dimmable luminaire (DALI)</b>
<b>... 2 ...</b>	<b>Dimmable luminaire (DALI D4i)</b>
<b>... 3 ...</b>	<b>Luminaire with Zhaga-18 interface for communication</b>

**Accessories Metaspot 3 external, for retro-fitting**

Part number	Colour	Description
<b>122 0 573 940</b>	black	<b>Cowl</b> , stainless steel, to avoid lateral glare, for retro-fitting
<b>122 0 573 960</b>	white	
<b>122 0 573 950</b>	silver grey	

**Accessories Metaspot 3 internal, factory fitted (not available for Darkring Optic/Street Optic)**

Part number	Description
<b>129 0 730 940</b>	<b>Radial louvre</b> , internal (factory fitted), to reduce lateral glare
<b>129 0 754 000</b>	<b>Honeycomb louvre</b> , internal (factory fitted), to avoid glare

**Accessories Metaspot 3 pole luminaire**

Part number	Part number	Colour	Description
<b>120 0 699 940</b>	<b>120 0 700 940</b>	black	<b>Post-top fitter</b> for insertion, with Zhaga-18 interface, with 8 m cable, for control and monitoring of max. 4 luminaires with D4i LED driver
<b>120 0 699 960</b>	<b>120 0 700 960</b>	white	
<b>120 0 699 950</b>	<b>120 0 700 950</b>	silver grey	

**LED** Luminaires available in 2200 K or other colour temperatures upon request



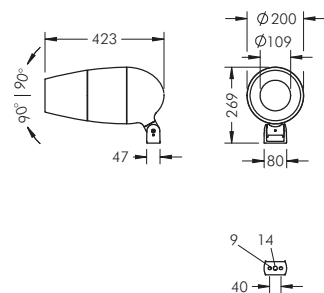

**Metaspot Gobo**

With high performance LED module, integral temperature monitoring device, CRI: > 70, Colour tolerance: max. 3 SDCM  
 Service life: L80/B10 > 50 000 h  
 protection class I, IP65  $\diamond \triangle \triangle$ , IK08  
 windage area AW 0,077 m<sup>2</sup>,  
 corrosion-resistant die cast aluminium housing AlSi12, polyester powder coated, focusable lens, carrier for gobos and colour filters, active ventilation, all exterior steel parts are stainless steel, tempered safety glass, silicon gasket, toolless twist lock for closure, mounting bracket: 2 drilled holes  $\varnothing$  9 mm, spacing 40 mm, 1 centre hole  $\varnothing$  14 mm, tilt range 180°, M20 cable gland, integral driver (AC/DC)

**Metaspot Gobo pole luminaire**

With high performance LED module, integral temperature monitoring device, CRI: > 70, Colour tolerance: max. 3 SDCM  
 Service life: L80/B10 > 50 000 h  
 protection class I, IP65  $\diamond \triangle \triangle$ , IK08  
 windage area AW 0,077 mm<sup>2</sup>,  
 corrosion-resistant die cast aluminium housing AlSi12, polyester powder coated, focusable lens, carrier for gobos and colour filters, active ventilation, all exterior steel parts are stainless steel, tempered safety glass, silicon gasket, toolless twist lock for closure, for installation on poles  $\varnothing$  60 - 100 mm, tiltable base made of powder coated aluminium, 2 drilled holes  $\varnothing$  9 mm, spacing 95 mm, 1 centre hole  $\varnothing$  40 mm, tilt range 90°, swivel range 360°, M20 cable gland, integral driver (AC/DC)

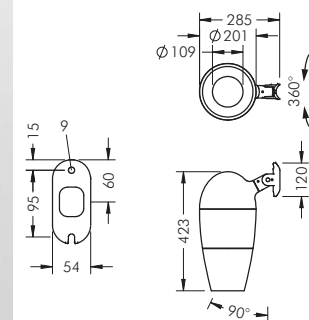

**Metaspot Gobo, 45 mm focal length**

Part number	Colour	Weight	Light source	Luminous flux	Beam angle
<b>8 244 044 069</b>	black	6.5 kg	1 x LED module 49 W cool white (6500 K)	1535 lm	41°
<b>8 244 064 069</b>	white				
<b>8 244 054 069</b>	silver grey				

Part number	Colour	Weight	Light source	Luminous flux	Beam angle
<b>8 244 046 069</b>	black	6.5 kg	1 x LED module 49 W warm white (3000 K)	1401 lm	41°
<b>8 244 066 069</b>	white				
<b>8 244 056 069</b>	silver grey				

**Metaspot Gobo, 63 mm focal length**

Part number	Colour	Weight	Light source	Luminous flux	Beam angle
<b>8 244 044 059</b>	black	6.5 kg	1 x LED module 49 W cool white (6500 K)	1127 lm	29°
<b>8 244 064 059</b>	white				
<b>8 244 054 059</b>	silver grey				

Part number	Colour	Weight	Light source	Luminous flux	Beam angle
<b>8 244 046 059</b>	black	6.5 kg	1 x LED module 49 W warm white (3000 K)	1029 lm	29°
<b>8 244 066 059</b>	white				
<b>8 244 056 059</b>	silver grey				

**Metaspot Gobo, 85 mm focal length**

Part number	Colour	Weight	Light source	Luminous flux	Beam angle
<b>8 244 044 049</b>	black	6.5 kg	1 x LED module 49 W cool white (6500 K)	1496 lm	22°
<b>8 244 064 049</b>	white				
<b>8 244 054 049</b>	silver grey				

Part number	Colour	Weight	Light source	Luminous flux	Beam angle
<b>8 244 046 049</b>	black	6.5 kg	1 x LED module 49 W warm white (3000 K)	1362 lm	22°
<b>8 244 066 049</b>	white				
<b>8 244 056 049</b>	silver grey				

**Metaspot Gobo, 150 mm focal length**

Part number	Colour	Weight	Light source	Luminous flux	Beam angle
<b>8 244 044 019</b>	black	6.5 kg	1 x LED module 49 W cool white (6500 K)	1702 lm	14°
<b>8 244 064 019</b>	white				
<b>8 244 054 019</b>	silver grey				

Part number	Description
<b>... 6 ...</b>	<b>Luminaire with warm white LED module (3000 K)</b>
<b>... 1 ...</b>	<b>Dimmable version (DALI)</b>
<b>... 3 ...</b>	<b>Luminaire with Zhaga-18 interface for communication</b>

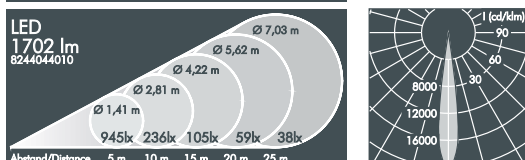
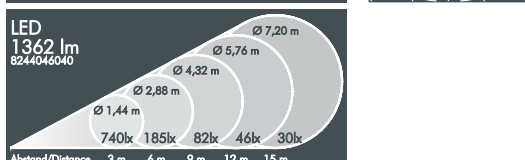
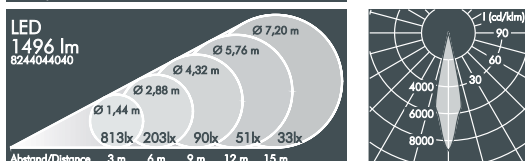
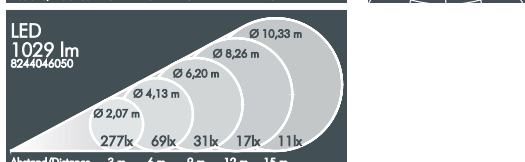
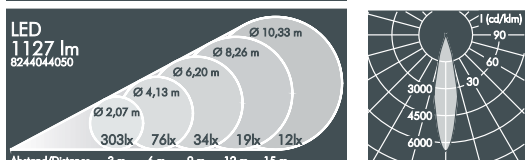
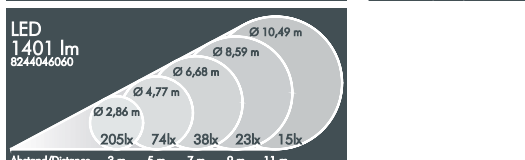
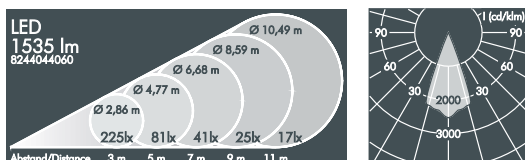

LED

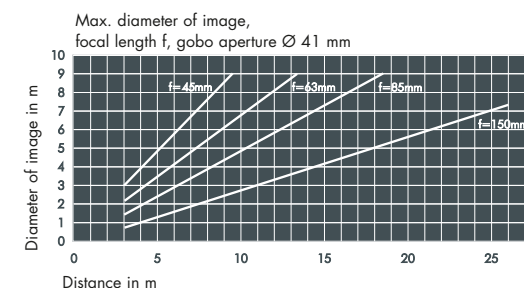
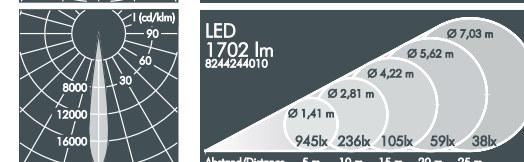

LED



**Metaspot Gobo pole luminaire, 45 mm focal length**

Part number	Colour	Weight	Light source	Luminous flux	Beam angle
<b>8 244 244 069</b>	black	6.5 kg	1 x LED module 49 W cool white (6500 K)	1535 lm	41°
<b>8 244 264 069</b>	white				
<b>8 244 254 069</b>	silver grey				

**Metaspot Gobo pole luminaire, 63 mm focal length**

Part number	Colour	Weight	Light source	Luminous flux	Beam angle
<b>8 244 244 059</b>	black	6.5 kg	1 x LED module 49 W cool white (6500 K)	1127 lm	29°
<b>8 244 264 059</b>	white				
<b>8 244 254 059</b>	silver grey				

**Metaspot Gobo pole luminaire, 85 mm focal length**

Part number	Colour	Weight	Light source	Luminous flux	Beam angle
<b>8 244 244 049</b>	black	6.5 kg	1 x LED module 49 W cool white (6500 K)	1496 lm	22°
<b>8 244 264 049</b>	white				
<b>8 244 254 049</b>	silver grey				

**Metaspot Gobo pole luminaire, 150 mm focal length**

Part number	Colour	Weight	Light source	Luminous flux	Beam angle
<b>8 244 244 019</b>	black	6.5 kg	1 x LED module 49 W cool white (6500 K)	1702 lm	14°
<b>8 244 264 019</b>	white				
<b>8 244 254 019</b>	silver grey				

Part number	Description
<b>... 6 ...</b>	<b>Luminaire with warm white LED module (3000 K)</b>
<b>... 1 ...</b>	<b>Dimmable version (DALI)</b>
<b>... 2 ...</b>	<b>Dimmable version (DALI D4i)</b>
<b>... 3 ...</b>	<b>Luminaire with Zhaga-18 interface for communication</b>

**Accessoires Metaspot Gobo \***

Part number	Description
<b>129 0 780 000</b>	<b>Framer</b> , for sharp edges on 3- or 4-sided images
	Pattern
<b>129 0 489 000</b>	waves
<b>129 0 490 000</b>	stars
<b>129 0 491 000</b>	hash

Custom made gobos can be produced from image data in one of the following file formats:  
**EPS** (min. 300 dpi), **TIF** (min. 300 dpi), **JPG** (in low compression). Max. image size D on gobo: D = 38 mm  
 \* **Dichroic colour filter** (yellow, red, blue, green) are available upon request.

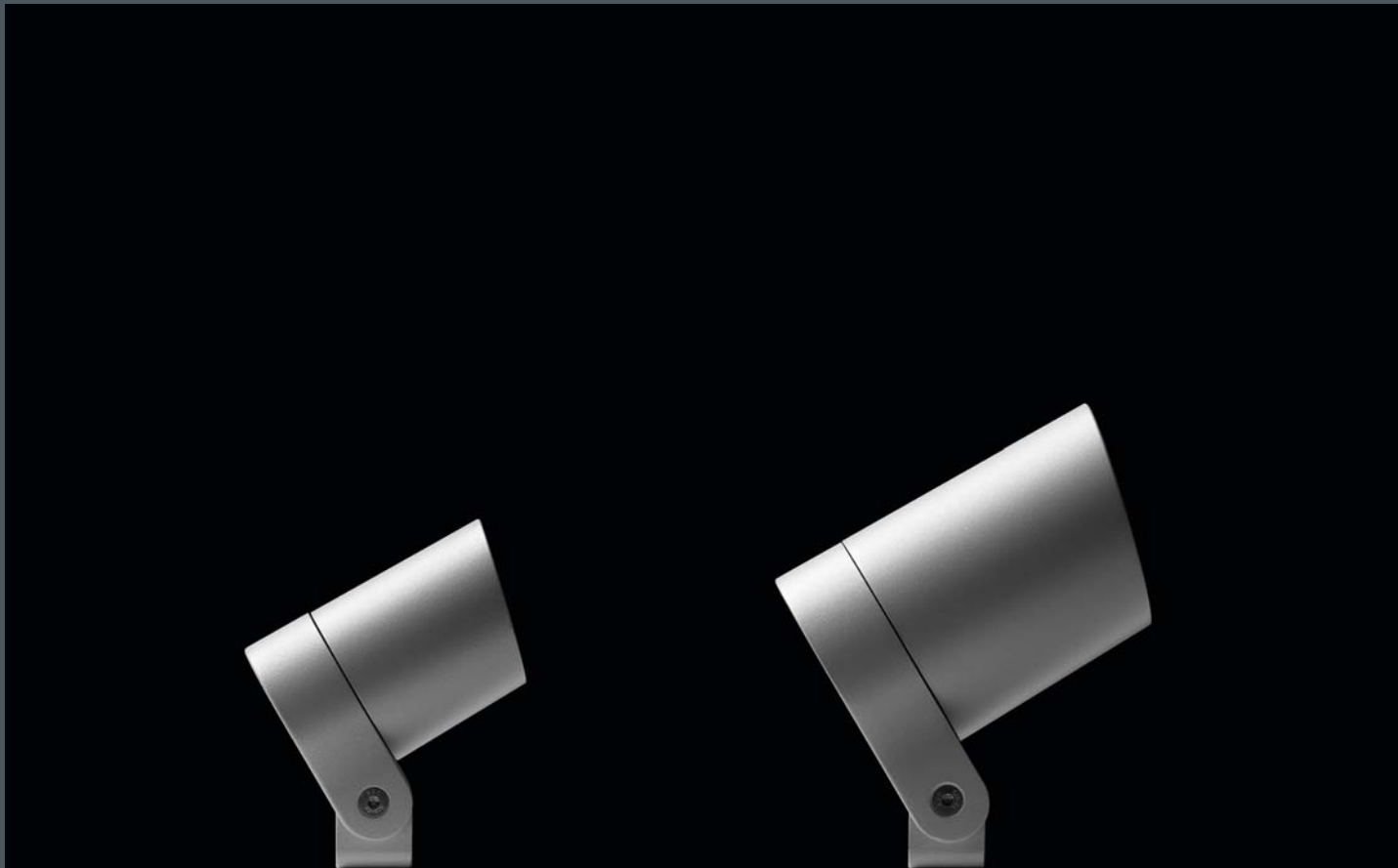

Minispot are cylindrical floodlights with very compact dimensions. With their minimalist design these luminaires are ideal for discrete installation on façades and for use in landscape lighting. Dimmable versions for 48 Volt power supply are available as well as luminaires that can be connected to 230 Volt directly. In addition, there are CASAMBI® ready versions with monochrome or RGBW LEDs that can be controlled with an app. With their wide choice of optics and wattages Minispot floodlights are versatile tools for accent lighting in exterior spaces.



Minispot floodlights are available as versions with RGBW LEDs. Light colours can be set easily via the CASAMBI®-App without using any complicated DMX control system.

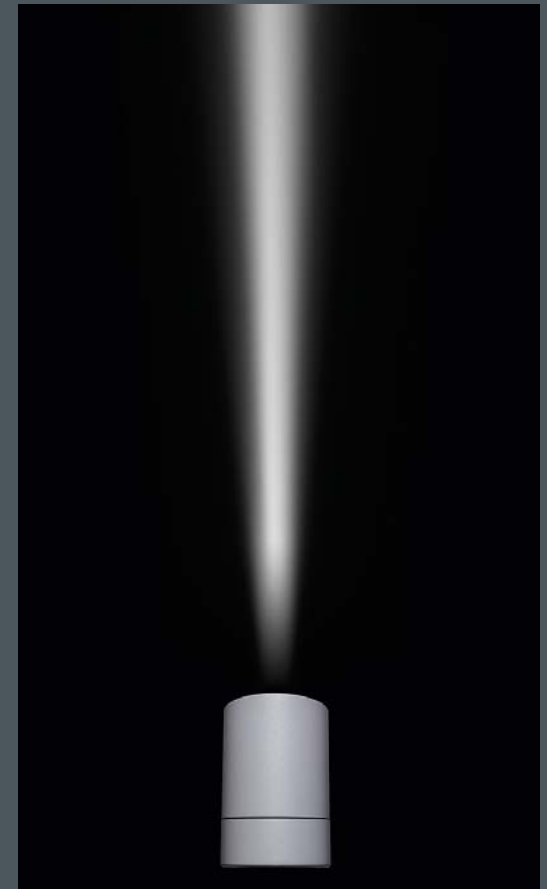

Narrow beam light distributions with reduced stray light are used for accent lighting on façades and for objects.



The slanted front of the luminaire serves as a glare shield. For improved maintenance rain and dirt can flow unimpeded over the flush lens.



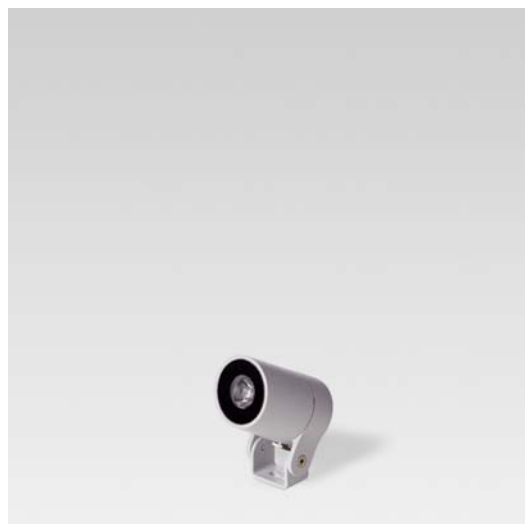
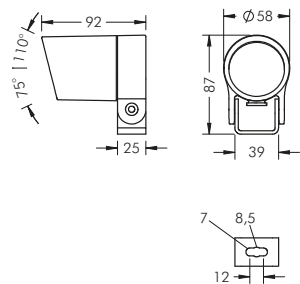

### Minispot 1

With high performance LED module, CRI: > 80, Colour tolerance: max. 2 SDCM  
 Service life: L90/B10 > 50 000 h  
 protection class III ⚡, IP65 ⚡, IK08  
 windage area AWW 0,006 m<sup>2</sup>, corrosion-resistant die cast aluminium housing AlSi12, polyester powder coated, with precise PMMA optic, all exterior steel parts are stainless steel, tempered safety glass, silicon gasket, 2 stainless steel screws, mounting bracket: 1 elongated hole Ø 7 mm, spacing 12 mm, 1 centre hole Ø 8,5 mm, tilt range 185°, M16 cable gland, 48 V DC: integral constant current control

### Minispot 2

With high performance LED module, CRI: > 80, Colour tolerance: max. 2 SDCM  
 Service life: L90/B10 > 50 000 h  
 protection class I or III ⚡, IP65 ⚡, IK08  
 windage area AWW 0,01 m<sup>2</sup>, corrosion-resistant die cast aluminium housing AlSi12, polyester powder coated, with reflector or precise PMMA optic, all exterior steel parts are stainless steel, tempered safety glass, silicon gasket, 2 stainless steel screws, mounting bracket: 1 elongated hole Ø 7 mm, spacing 18 mm, 1 centre hole Ø 8,5 mm, tilt range 200°, M20 cable gland, 48 V DC: integral constant current control, 230 V AC: integral driver

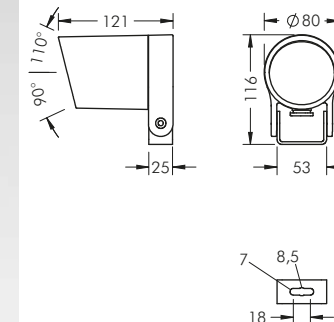
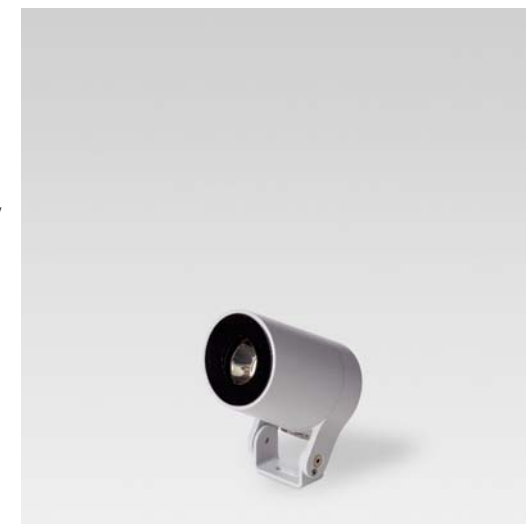

#### Minispot 1, narrow beam (48 V DC, dimmable DALI)

Part number	Colour	Weight	Light source	Luminous flux	Beam angle γ (FWHM)
8 924 046 119	black	0.4 kg	1 x LED 2 W warm white (3000 K)	148 lm	5°
8 924 066 119	white				
8 924 056 119	silver grey				

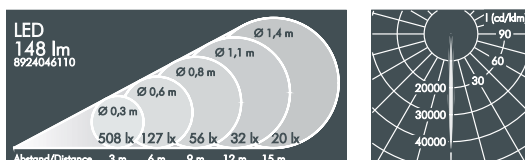

#### Minispot 1, linear beam spread, horizontal (48 V DC, dimmable DALI)

Part number	Colour	Weight	Light source	Luminous flux	Beam angle γ (FWHM)
8 924 046 139	black	0.4 kg	1 x LED 2 W warm white (3000 K)	142 lm	C 0 – 180
8 924 066 139	white				C 90 – 270
8 924 056 139	silver grey				7°

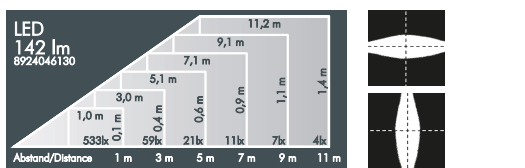

#### ... 2. Luminaire with linear beam spread, vertical (48 V DC, dimmable DALI)

#### Minispot 1, medium wide beam (48 V DC, dimmable DALI)

Part number	Colour	Weight	Light source	Luminous flux	Beam angle γ (FWHM)
8 924 046 149	black	0.4 kg	1 x LED 2 W warm white (3000 K)	139 lm	25°
8 924 066 149	white				
8 924 056 149	silver grey				

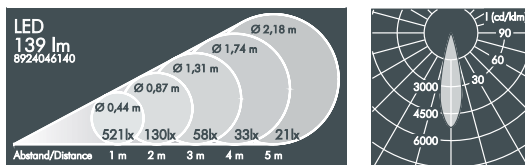

#### Minispot 1, wide beam (48 V DC, dimmable DALI)

Part number	Colour	Weight	Light source	Luminous flux	Beam angle γ (FWHM)
8 924 046 159	black	0.4 kg	1 x LED 2 W warm white (3000 K)	136 lm	44°
8 924 066 159	white				
8 924 056 159	silver grey				

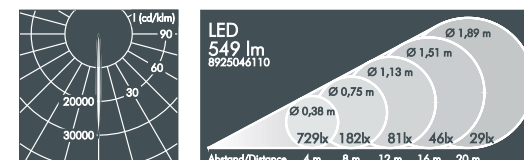
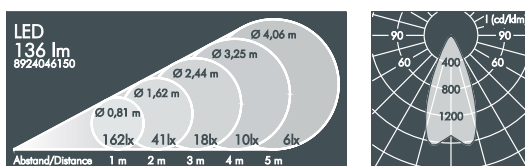

#### Minispot 2, narrow beam (48 V DC, dimmable DALI)

Part number	Colour	Weight	Light source	Luminous flux	Beam angle γ (FWHM)
8 925 046 119	black	0.8 kg	1 x LED module 8 W warm white (3000 K)	549 lm	6°
8 925 066 119	white				
8 925 056 119	silver grey				



#### Minispot 2, linear beam spread, horizontal (48 V DC, dimmable DALI)

Part number	Colour	Weight	Light source	Luminous flux	Beam angle γ (FWHM)
8 925 046 129	black	0.8 kg	1 x LED module 8 W warm white (3000 K)	506 lm	C 0 – 180
8 925 066 129	white				C 90 – 270
8 925 056 129	silver grey				34°

#### ... 3. Luminaire with linear beam spread, vertical (48 V DC, dimmable DALI)

#### Minispot 2, medium wide beam (48 V DC, dimmable DALI)

Part number	Colour	Weight	Light source	Luminous flux	Beam angle γ (FWHM)
8 925 046 149	black	0.8 kg	1 x LED module 8 W warm white (3000 K)	546 lm	23°
8 925 066 149	white				
8 925 056 149	silver grey				



#### Minispot 2, wide beam (48 V DC, dimmable DALI)

Part number	Colour	Weight	Light source	Luminous flux	Beam angle γ (FWHM)
8 925 046 159	black	0.8 kg	1 x LED module 8 W warm white (3000 K)	573 lm	59°
8 925 066 159	white				
8 925 056 159	silver grey				

Part number	Description
... 0 ..	Luminaire 48 V DC, on/off
... 7 ...	Luminaire with warm white LED module (2700 K)
... 5 ...	Luminaire with neutral white LED module (4000 K)

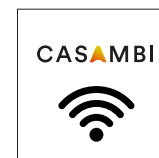

Part number	Description
... 0 ..	Luminaire 48 V DC on/off
... 3 ..	Luminaire dimmable (48 V), CASAMBI®
... 7 ...	Luminaire with warm white LED module (2700 K)
... 5 ...	Luminaire with neutral white LED module (4000 K)
... 9 3 ..	Luminaire with LED module RGBW max. 7 W, CASAMBI®

#### Accessories Minispot 1

Part number	Description
119 0 071 000	Power supply, 48 V, max. 70 W*, weather-resistant polycarbonate, grey, IP67
119 0 072 000	Power supply, 48 V, max. 150 W*, weather-resistant polycarbonate, grey, IP67

\*additional wattages upon request

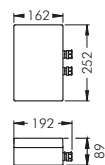

Part number	Description
129 0 901 000	honeycomb louvre, internal (factory fitted), to avoid glare
129 0 731 940	black
129 0 731 960	white
129 0 731 950	silver grey



LED  
 Luminaire available in 2700 K or other colour temperatures upon request



Part number	Description
8 926 .. 6 0 ..	Luminaire 230 V AC, on/off (integral driver) 1 x LED module 10 W with warm white colour temperature (3000 K)
8 926 .. 7 0 ..	Luminaire 230 V AC, on/off (integral driver) 1 x LED module 10 W with warm white colour temperature (2700 K)
8 926 .. 5 0 ..	Luminaire 230 V AC, on/off (integral driver) 1 x LED module 10 W with neutral white colour temperature (4000 K)



LED  
 Luminaire available in 2700 K or other colour temperatures upon request



Part number	Description
119 0 071 000	Power supply, 48 V, max. 70 W*, weather-resistant polycarbonate, grey, IP67
119 0 072 000	Power supply, 48 V, max. 150 W*, weather-resistant polycarbonate, grey, IP67
129 0 902 000	Honeycomb louvre, internal (factory fitted), to avoid glare
129 0 731 940	black
129 0 731 960	white
129 0 731 950	silver grey

#### Accessories Minispot 2

Part number	Description
119 0 071 000	Power supply, 48 V, max. 70 W*, weather-resistant polycarbonate, grey, IP67
119 0 072 000	Power supply, 48 V, max. 150 W*, weather-resistant polycarbonate, grey, IP67
129 0 902 000	Honeycomb louvre, internal (factory fitted), to avoid glare
129 0 731 940	black
129 0 731 960	white
129 0 731 950	silver grey

\*additional wattages upon request