

The new Nightfocus series of façade luminaires has a clear concept of discreet, nearly “invisible” installation. The product design follows this aim uncompromisingly, resulting in a clear and simple rectangular body. Miniature metal halide lamps and LEDs made it possible to design an extremely compact luminaire. This series meets the demands of sophisticated architectural lighting; gimbal mounted adjustable reflectors or LED modules with various distributions can be focused with precision and then locked into place. A modular system of two luminaires offers a high degree of flexibility for many lighting tasks.

Design: Roy Fleetwood

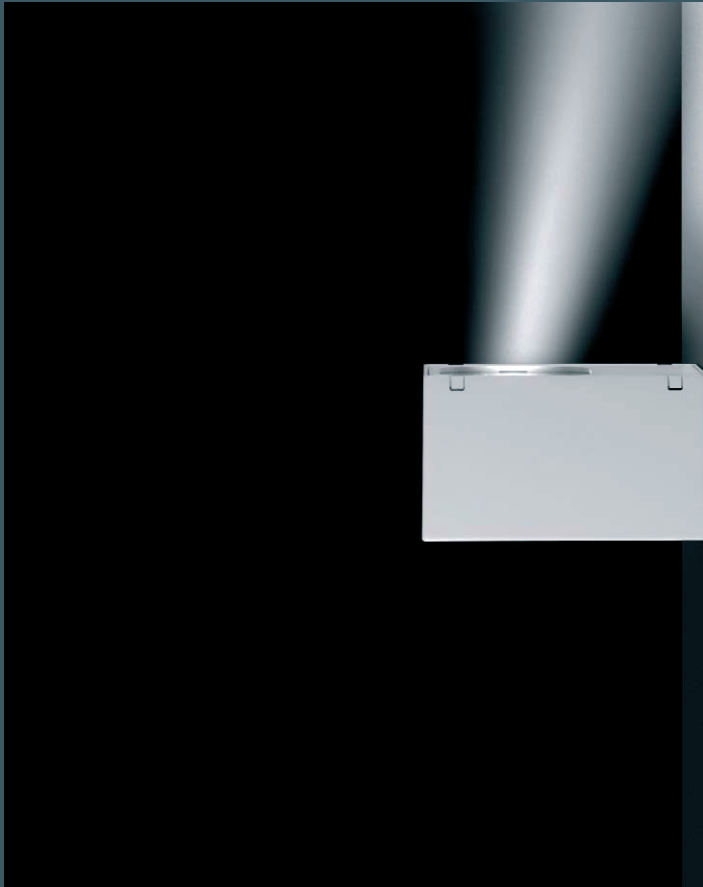

The Nightfocus range offers a choice of rotationally symmetrical reflectors with various beam angles or asymmetrical reflectors. Alternatively, these luminaires are available with LEDs in various distributions.

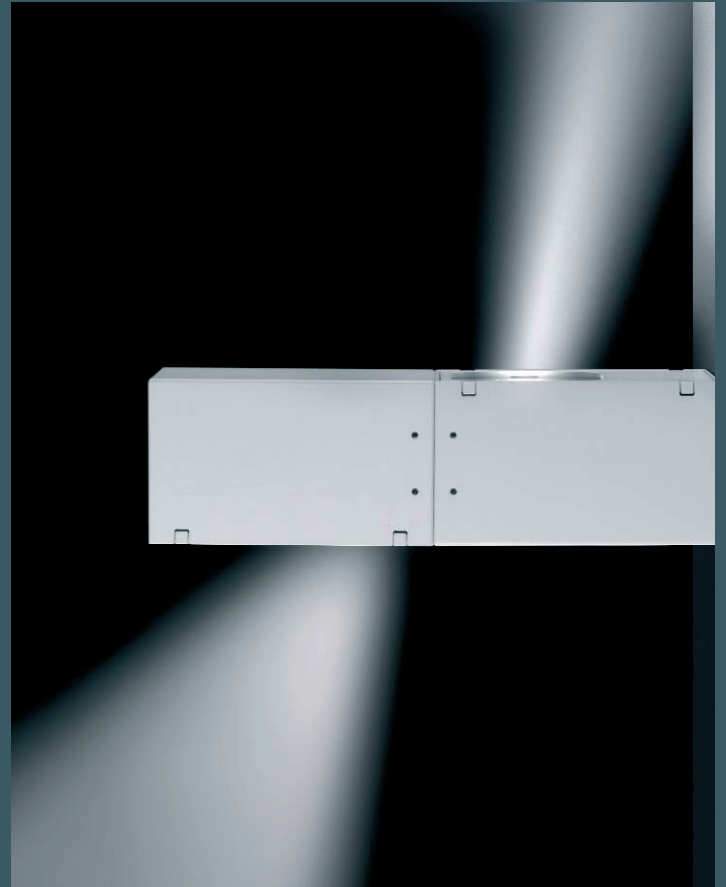

Two modules with differing wattages and beam distributions can be combined together as up- and downlight.

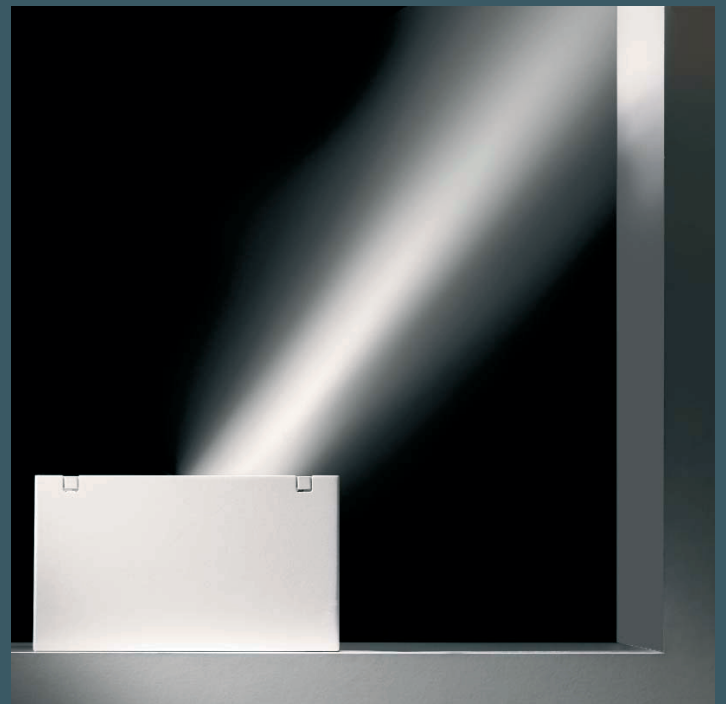

The luminaires for mounting lengthwise are suitable for situations where the housing should not protrude from the façade, e.g. on ledges or window reveals.

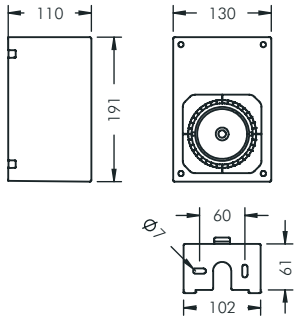

Nightfocus Rotationally symmetrical narrow beam

For ceramic metal halide lamps (HIT-TC-CE), protection class I, IP65 , IK08 die cast aluminium housing, polyester powder coated, gimbal mounted high purity aluminium reflector, adjustment range 0-15°, all exterior steel parts stainless steel, tempered safety glass, silicon gasket, closure with 4 stainless steel screws, wall mounting: 2 drilled holes \varnothing 7 mm, spacing 60 mm, cable entry: up to \varnothing 13 mm recessed cable, integral electronic ballast, supplied without lamp

Nightfocus 20 W, gimbal mounted reflector, rotationally symmetrical, narrow beam

Part number	Colour	Lamp	Lampholder	Weight	Beam angle !
8 391 041 009	black	Philips CDM-Tm	PGJ5	3.4 kg	7°
8 391 061 009	white	20 W			
8 391 051 009	silver grey				

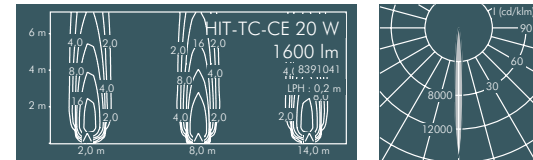

Part number	Colour	Lamp	Lampholder	Weight	Beam angle !
8 393 041 009	black	General Electric	GU6.5	3.4 kg	7°
8 393 061 009	white	CMH 20 W/			
8 393 051 009	silver grey	Osram HCL-TF 20 W			

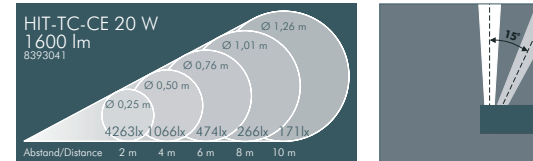

Nightfocus 35 W, gimbal mounted reflector, rotationally symmetrical, narrow beam

Part number	Colour	Lamp	Lampholder	Weight	Beam angle !
8 392 041 009	black	Philips CDM-Tm	PGJ5	3.4 kg	9°
8 392 061 009	white	35 W			
8 392 051 009	silver grey				

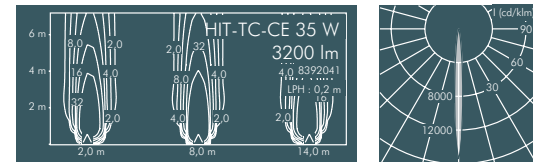

Part number	Colour	Lamp	Lampholder	Weight	Beam angle !
8 394 041 009	black	General Electric	GU6.5	3.4 kg	9°
8 394 061 009	white	CMH 35 W/			
8 394 051 009	silver grey	Osram HCL-TF 35 W			

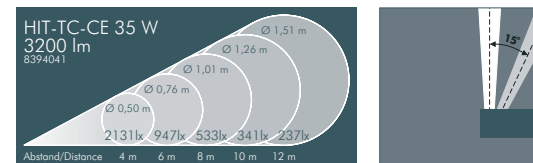

Nightfocus 20/35 W, gimbal mounted reflector, rotationally symmetrical, narrow beam

Part number	Description
. ... 1.. 009	Luminaire to be mounted lengthwise

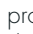

Nightfocus
Rotationally symmetrical
wide beam

For ceramic metal halide lamps (HIT-TC-CE), protection class I, IP65 , IK08 die cast aluminium housing, polyester powder coated, gimbal mounted high purity aluminium reflector, adjustment range 0-15°, all exterior steel parts stainless steel, tempered safety glass, silicon gasket, closure with 4 stainless steel screws, wall mounting: 2 drilled holes Ø 7 mm, spacing 60 mm, cable entry: up to Ø 13 mm recessed cable, integral electronic ballast, supplied without lamp

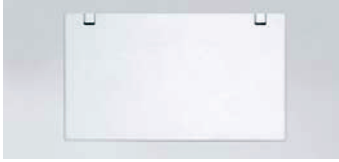
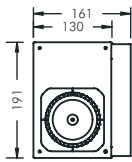
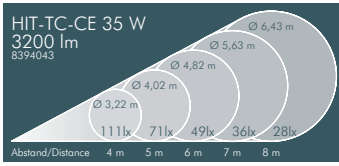
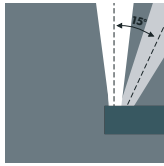
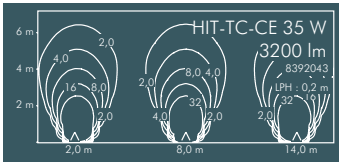
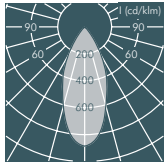
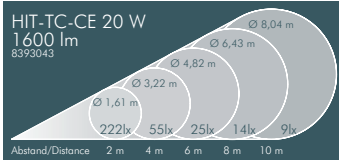
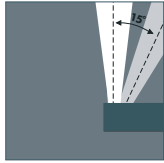
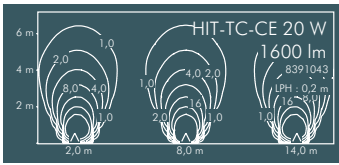
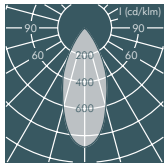
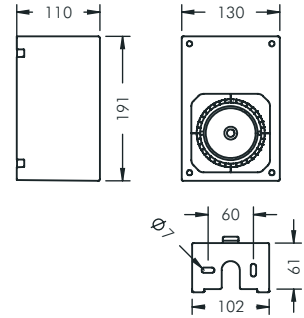

Nightfocus 20 W, gimbal mounted reflector, rotationally symmetrical, wide beam

Part number	Colour	Lamp	Lampholder	Weight	Beam angle !
8 391 043 009	black	Philips CDM-Tm	PGJ5	3.4 kg	44°
8 391 063 009	white	20 W			
8 391 053 009	silver grey				

Part number	Colour	Lamp	Lampholder	Weight	Beam angle !
8 393 043 009	black	General Electric	GU6,5	3.4 kg	44°
8 393 063 009	white	CMH 20 W/			
8 393 053 009	silver grey	Osram HCITF 20 W			

Nightfocus 35 W, gimbal mounted reflector, rotationally symmetrical, wide beam

Part number	Colour	Lamp	Lampholder	Weight	Beam angle !
8 392 043 009	black	Philips CDM-Tm	PGJ5	3.4 kg	44°
8 392 063 009	white	35 W			
8 392 053 009	silver grey				

Part number	Colour	Lamp	Lampholder	Weight	Beam angle !
8 394 043 009	black	General Electric	GU6,5	3.4 kg	44°
8 394 063 009	white	CMH 35 W/			
8 394 053 009	silver grey	Osram HCITF 35 W			

Nightfocus 20/35 W, gimbal mounted reflector, rotationally symmetrical, wide beam

Part number	Description
. ... 1.. 009	Luminaire to be mounted lengthwise

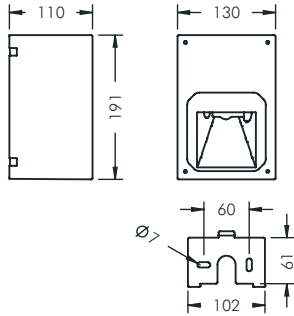

Nightfocus Asymmetrical wide beam

For ceramic metal halide lamps (HIT-TC-CE), protection class I, IP65 \diamond \triangle \triangle , IK08 die cast aluminium housing, polyester powder coated, asymmetrical aluminium reflector, rotatable 4 x 90°, all exterior steel parts stainless steel, tempered safety glass, silicon gasket, closure with 4 stainless steel screws, wall mounting: 2 drilled holes \varnothing 7 mm, spacing 60 mm, cable entry: up to \varnothing 13 mm recessed cable, integral electronic ballast, supplied without lamp

Nightfocus 20 W, asymmetrical wide beam

Part number	Colour	Lamp	Lampholder	Weight	Main beam angle
8 391 044 009	black	Philips CDM-Tm	PGJ5	3.4 kg	43°
8 391 064 009	white	20 W			
8 391 054 009	silver grey				

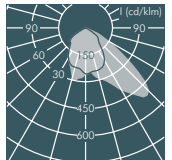
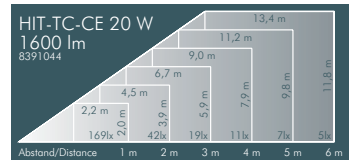

Part number	Colour	Lamp	Lampholder	Weight	Main beam angle
8 393 044 009	black	General Electric	GU6.5	3.4 kg	43°
8 393 064 009	white	CMH 20 W/			
8 393 054 009	silver grey	Osram HCLTF 20 W			

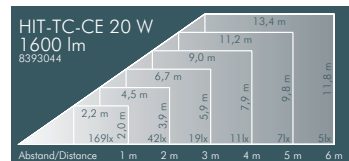

Nightfocus 35 W, asymmetrical wide beam

Part number	Colour	Lamp	Lampholder	Weight	Main beam angle
8 392 044 009	black	Philips CDM-Tm	PGJ5	3.4 kg	43°
8 392 064 009	white	35 W			
8 392 054 009	silver grey				

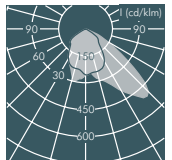
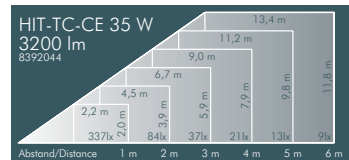

Part number	Colour	Lamp	Lampholder	Weight	Main beam angle
8 394 044 009	black	General Electric	GU6.5	3.4 kg	43°
8 394 064 009	white	CMH 35 W/			
8 394 054 009	silver grey	Osram HCLTF 35 W			

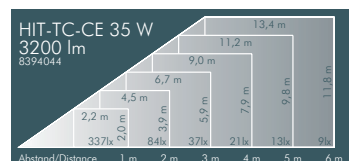

Nightfocus 20/35 W, asymmetrical wide beam

Part number	Description
... 1.. 009	Luminaire to be mounted lengthwise

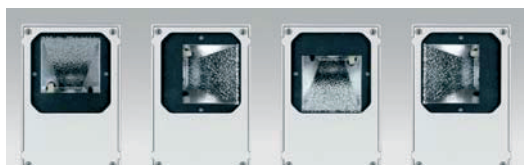
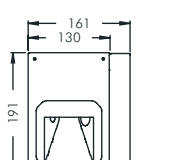
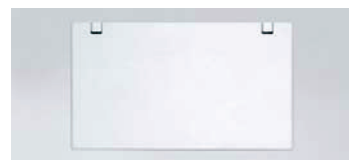

The asymmetrical reflector unit can be rotated 4 x 90°, thus changing the direction of the light output.

Lamps

HIT-TC-CE



HIT-TC-CE



Nightfocus LED

With 5 x 1 W high performance LEDs, integral thermal monitoring device, protection class I, IP65 , IK08 die cast aluminium housing, polyester powder coated, gimbal mounted LED board, adjustment range 0-15°, all exterior steel parts stainless steel, tempered safety glass, silicon gasket, closure with 4 stainless steel screws, wall mounting: 2 drilled holes Ø 7mm, spacing 60mm, cable entry: up to Ø 13mm recessed cable, on-board driver and integral transformer

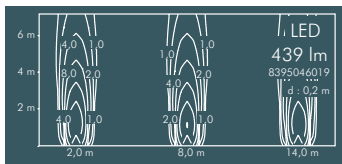
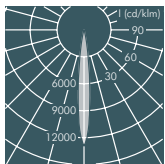
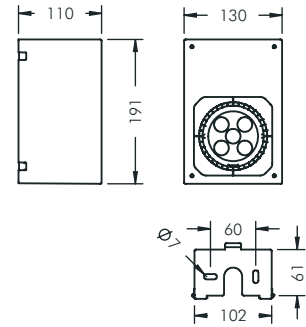

Nightfocus LED, gimbal mounted, narrow beam

Part number	Colour	Lamp	Weight	Beam angle ! #
8 395 046 019	black	5 x LED 1 W warm white	3.4 kg	11°
8 395 066 019	white			
8 395 056 019	silver grey			

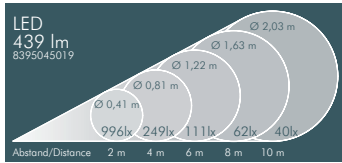
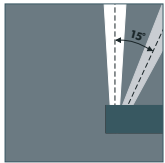

Part number	Colour	Lamp	Weight	Beam angle ! #
8 395 045 019	black	5 x LED 1 W neutral white	3.4 kg	11°
8 395 065 019	white			
8 395 055 019	silver grey			

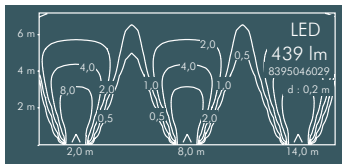
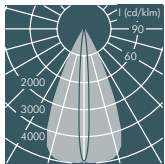

Nightfocus LED, gimbal mounted, linear beam spread

Part number	Colour	Lamp	Weight	Beam angle ! #
8 395 046 029	black	5 x LED 1 W warm white	3.4 kg	C 0 - 180 C 90 - 270
8 395 066 029	white			
8 395 056 029	silver grey			

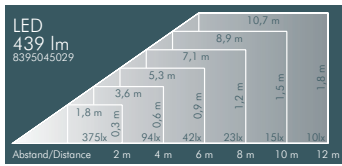

Part number	Colour	Lamp	Weight	Beam angle ! #
8 395 045 029	black	5 x LED 1 W neutral white	3.4 kg	C 0 - 180 C 90 - 270
8 395 065 029	white			
8 395 055 029	silver grey			

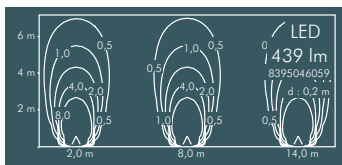
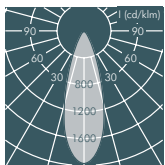

Nightfocus LED, gimbal mounted, wide beam

Part number	Colour	Lamp	Weight	Beam angle ! #
8 395 046 059	black	5 x LED 1 W warm white	3.4 kg	33°
8 395 066 059	white			
8 395 056 059	silver grey			

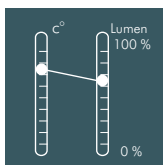
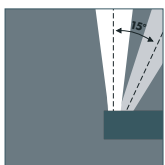

The integral thermal monitoring device adjusts the light output if a change in temperature makes it necessary. This feedback function contributes to a longer life span of the LED modules.

Part number	Colour	Lamp	Weight	Beam angle ! #
8 395 045 059	black	5 x LED 1 W neutral white	3.4 kg	33°
8 395 065 059	white			
8 395 055 059	silver grey			

Nightfocus LED, gimbal mounted

Part number	Description
... 1.. 009	Luminaire to be mounted lengthwise

Light source

LEDs, replacement modules available



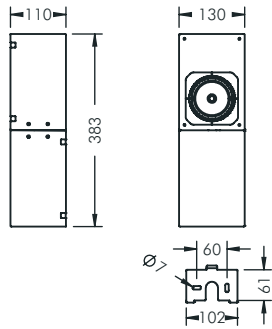

Nightfocus Modular System

For ceramic metal halide lamps (HITFC-CE), protection class I, IP65 $\diamond \triangle \triangle$, IK08 die cast aluminium housing, polyester powder coated, aluminium reflector, all exterior steel parts stainless steel, tempered safety glass, silicon gasket, closure with 4 stainless steel screws, wall mounting: 2 drilled holes \varnothing 7 mm, spacing 60 mm, cable entry: up to \varnothing 13 mm recessed cable, integral electronic ballast, supplied without lamp.



Lamp
HITFC-CE Philips CDM-Tm 20/35 W, PGJ5

Uplight module

Downlight module	1	narrow beam 1		wide beam 2		asymmetric beam 3	
		Light source	Philips CDM-Tm 20 W	Philips CDM-Tm 35 W	Philips CDM-Tm 20 W	Philips CDM-Tm 35 W	Philips CDM-Tm 20 W
narrow beam	Philips CDM-Tm 20 W	8 399 0.0 009	8 399 1.0 009	8 399 4.0 009	8 399 5.0 009	8 399 6.0 009	8 399 7.0 009
	Philips CDM-Tm 35 W	8 399 0.1 009	8 399 1.1 009	8 399 4.1 009	8 399 5.1 009	8 399 6.1 009	8 399 7.1 009
wide beam	Philips CDM-Tm 20 W	8 399 0.4 009	8 399 1.4 009	8 399 4.4 009	8 399 5.4 009	8 399 6.4 009	8 399 7.4 009
	Philips CDM-Tm 35 W	8 399 0.5 009	8 399 1.5 009	8 399 4.5 009	8 399 5.5 009	8 399 6.5 009	8 399 7.5 009
asymmetric beam	Philips CDM-Tm 20 W	8 399 0.6 009	8 399 1.6 009	8 399 4.6 009	8 399 5.6 009	8 399 6.6 009	8 399 7.6 009
	Philips CDM-Tm 35 W	8 399 0.7 009	8 399 1.7 009	8 399 4.7 009	8 399 5.7 009	8 399 6.7 009	8 399 7.7 009

- 8 399 .4. 009** **black**
- 8 399 .6. 009** **white**
- 8 399 .5. 009** **silver grey**

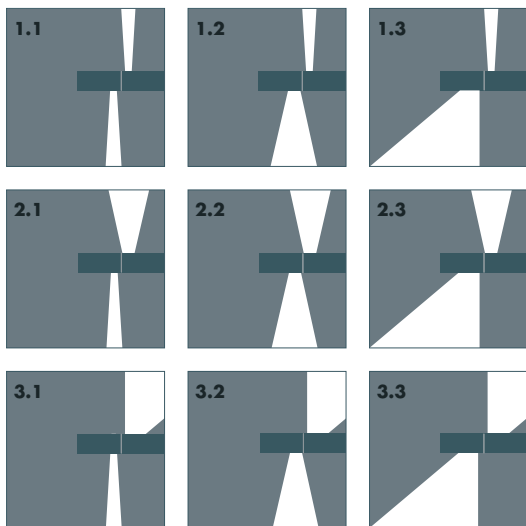

Lamp

HITTC-CE General Electric CMH 20/35 W,
HITTC-CE Osram HCl-TF 20/35 W, GU6.5



Uplight module

asymmetric beam 3		wide beam 2		narrow beam 1		Light source	Downlight module
General Electric CMH 35 W Osram HCl-TF 35 W	General Electric CMH 20 W Osram HCl-TF 20 W	General Electric CMH 35 W Osram HCl-TF 35 W	General Electric CMH 20 W Osram HCl-TF 20 W	General Electric CMH 35 W Osram HCl-TF 35 W	General Electric CMH 20 W Osram HCl-TF 20 W		
8 390 7.0 009	8 390 6.0 009	8 390 5.0 009	8 390 4.0 009	8 390 1.0 009	8 390 0.0 009	General Electric CMH 20 W Osram HCl-TF 20 W	wide beam 2
8 390 7.1 009	8 390 6.1 009	8 390 5.1 009	8 390 4.1 009	8 390 1.1 009	8 390 0.1 009	General Electric CMH 35 W Osram HCl-TF 35 W	
8 390 7.4 009	8 390 6.4 009	8 390 5.4 009	8 390 4.4 009	8 390 1.4 009	8 390 0.4 009	General Electric CMH 20 W Osram HCl-TF 20 W	asymmetric beam 3
8 390 7.5 009	8 390 6.5 009	8 390 5.5 009	8 390 4.5 009	8 390 1.5 009	8 390 0.5 009	General Electric CMH 35 W Osram HCl-TF 35 W	
8 390 7.6 009	8 390 6.6 009	8 390 5.6 009	8 390 4.6 009	8 390 1.6 009	8 390 0.6 009	General Electric CMH 20 W Osram HCl-TF 20 W	
8 390 7.7 009	8 390 6.7 009	8 390 5.7 009	8 390 4.7 009	8 390 1.7 009	8 390 0.7 009	General Electric CMH 35 W Osram HCl-TF 35 W	

8 390 .4. 009 **black**
8 390 .6. 009 **white**
8 390 .5. 009 **silver grey**

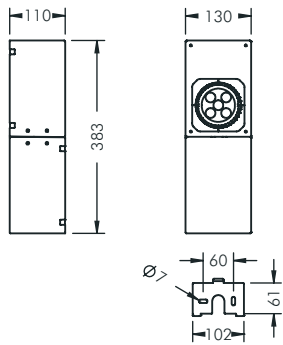

Nightfocus LED Modular System

With 5 x 1 W high performance LEDs, integral thermal monitoring device, protection class I, IP65 , IK08 die cast aluminium housing, polyester powder coated, gimbal mounted LED board, adjustment range 0-15°, all exterior steel parts stainless steel, tempered safety glass, silicon gasket, closure with 4 stainless steel screws, wall mounting: 2 drilled holes Ø 7 mm, spacing 60 mm, cable entry: up to Ø 13 mm recessed cable, on-board driver and integral transformer



Light source

LEDs, replacement modules available

Uplight module

Downlight module	Light source	narrow beam 1		linear beam
			5 x LED 1 W warm white	5 x LED 1 W neutral white
narrow beam 1	5 x LED 1 W warm white	8 398 1.1 009	8 398 2.1 009	8 398 3.1 009
	5 x LED 1 W neutral white	8 398 1.2 009	8 398 2.2 009	8 398 3.2 009
linear beam spread 2	5 x LED 1 W warm white	8 398 1.3 009	8 398 2.3 009	8 398 3.3 009
	5 x LED 1 W neutral white	8 398 1.4 009	8 398 2.4 009	8 398 3.4 009
wide beam 3	5 x LED 1 W warm white	8 398 1.5 009	8 398 2.5 009	8 398 3.5 009
	5 x LED 1 W neutral white	8 398 1.6 009	8 398 2.6 009	8 398 3.6 009

8 398 .4. 009

black

8 398 .6. 009

white

8 398 .5. 009

silver grey

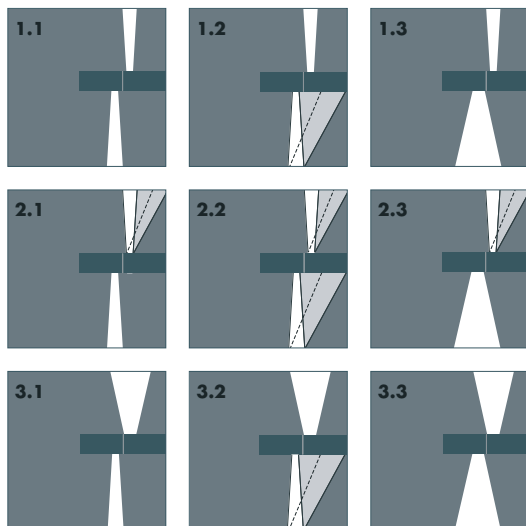

spread 2	wide beam 3	
5 x LED 1 W neutral white	5 x LED 1 W warm white	5 x LED 1 W neutral white
8 398 4.1 009	8 398 5.1 009	8 398 6.1 009
8 398 4.2 009	8 398 5.2 009	8 398 6.2 009
8 398 4.3 009	8 398 5.3 009	8 398 6.3 009
8 398 4.4 009	8 398 5.4 009	8 398 6.4 009
8 398 4.5 009	8 398 5.5 009	8 398 6.5 009
8 398 4.6 009	8 398 5.6 009	8 398 6.6 009

Accessories for Nightfocus 20/35 W narrow and wide beam

Part number	Colour	Description
123 0 301 000	yellow	Dichroic colour filter, internally fitted
123 0 307 000	blue	
123 0 303 000	red	
123 0 308 000	green	

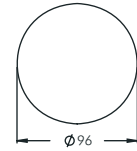
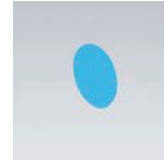

Part number	Description
123 0 300 000	Prismatic glass lens, to widen the beam angle

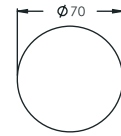
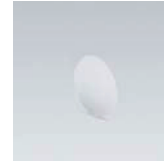

Part number	Description
123 0 299 940	Radial louvre, to reduce lateral glare

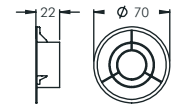

Accessories for Nightfocus 20/35 W, narrow beam

Part number	Description
123 0 302 000	Ribbed glass spreader lens, internally fitted, for linear beam control, continuously adjustable 360°

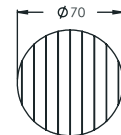
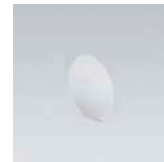

Accessories for Nightfocus 20/35 W, asymmetrical wide beam

Part number	Colour	Description
123 0 331 000	yellow	Dichroic colour filter, internally fitted
123 0 333 000	blue	
123 0 337 000	red	
123 0 338 000	green	

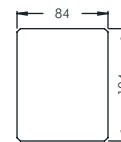

Part number	Description
123 0 315 940	Louvre, internally fitted, to reduce lateral glare

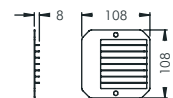

Nightfocus is a versatile luminaire range for façade illumination. A wide range of lighting design concepts can be accomplished at one level, with few installation points.

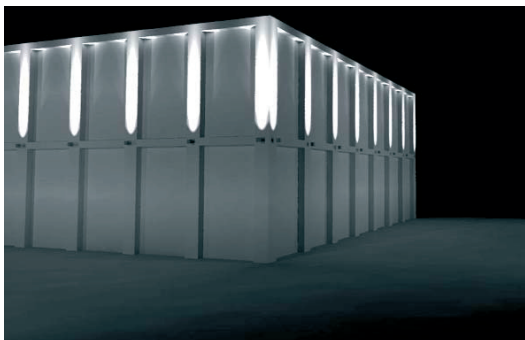

Vertical accent lighting with uplights

Rotationally symmetrical narrow beam reflectors or narrow beam LEDs

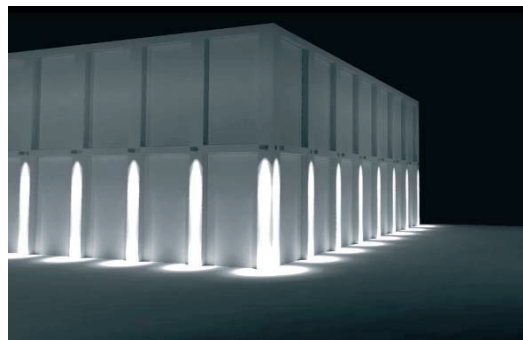

Vertical accent lighting with downlights

Rotationally symmetrical narrow beam reflectors or narrow beam LEDs

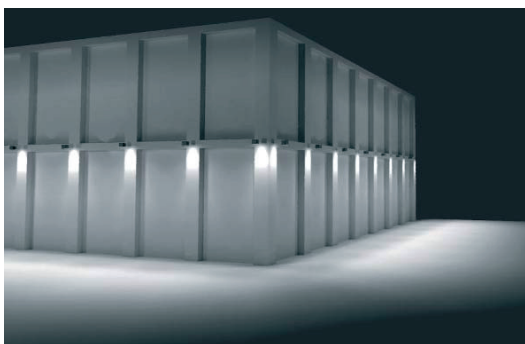

Uniform illumination of a plinth or area in front of a building

Asymmetrical wide beam reflectors

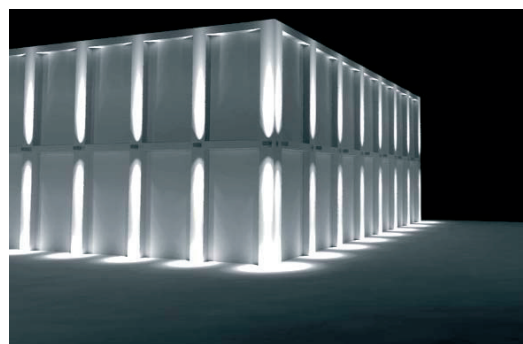

Vertical accent lighting with up/downlights

Modular system with rotationally symmetrical narrow beam reflectors or with narrow beam LEDs up and down

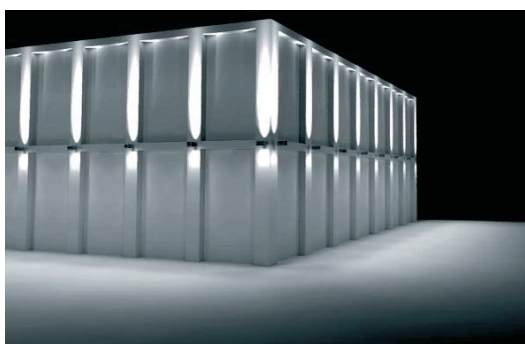

Vertical accent lighting with uplights/ uniform illumination with downlights

Modular system with rotationally symmetrical narrow beam reflectors or narrow beam LEDs upwards and with asymmetrical wide beam reflectors downwards

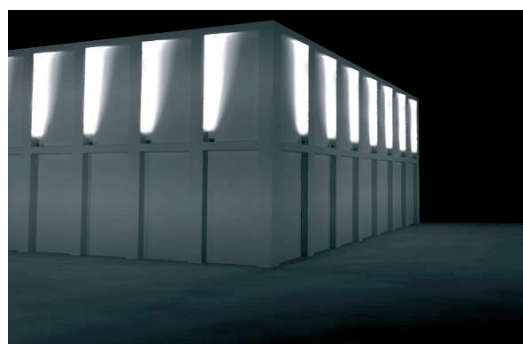

Illumination of alcoves

Luminaires mounted lengthwise with rotationally symmetrical or asymmetrical reflectors or with LEDs